

LOGOSOL

USER MANUAL

ORIGINAL USER MANUAL.

0458-395-2491

REV: 1

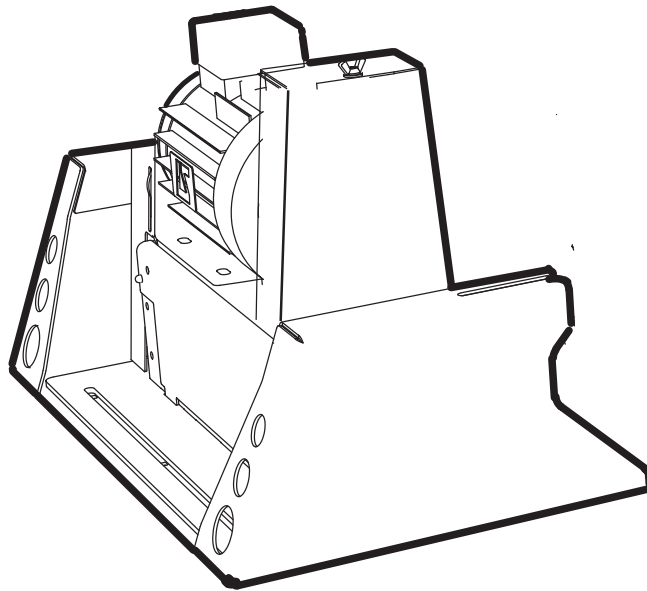

LOG MOULDER B701



Read through the user manual carefully and make sure you understand its contents before using the equipment.



This user manual contains important safety instructions.



WARNING! Incorrect use can result in serious or fatal injuries to the operator or others.

EN

THANKS FOR CHOOSING A LOGOSOL MACHINE!

We are very pleased that you have demonstrated your confidence in us by purchasing this machine and we will do our utmost to meet your expectations.

LOGOSOL has been manufacturing wood processing equipment since 1989, and during these years we have supplied approximately 100,000 machines to satisfied customers all around the world.

We are concerned with your safety and ensuring that you achieve the best possible results with your machine. We therefore recommend that you take the time to carefully read this user manual before using the machine. Remember that the machine itself is only a part of the value of the product. Much of the value is also to be found in the expertise we pass on to you in the user manual. It would be a pity if that was not utilised.

We hope you will be thoroughly satisfied with your new machine.



Bengt-Olov Byström
Founder,
Logosol in Härnösand



LOGOSOL continuously develops its products.
For this reason, we must reserve the right to modify
the configuration and design of our products.
Document: LOGOSOL LM 00-00141
Manual, part no.: 0458-395-2491
Last revised:
© 2026 LOGOSOL, Härnösand Sweden

TABLE OF CONTENTS

General	4
Description of the machine	4
Safety instructions	5
Control panel	7
Chip handling	7
Assembly	9
Assembly (Cutting equipment)	12
Positioning of log supports	15
Adjustment of planer blades	16
Maintenance	17
Milling of timber for house construction	18
Troubleshooting	19
Technical data	21
Machine declaration	22

GENERAL INFORMATION

This user manual and instructions for accessories must be considered as part of the machine and always be stored with the machine. They must also accompany the machine if the machine is sold.

The responsibility for ensuring that the machine is operated correctly and safely lies with the person who uses it.

COMPONENTS

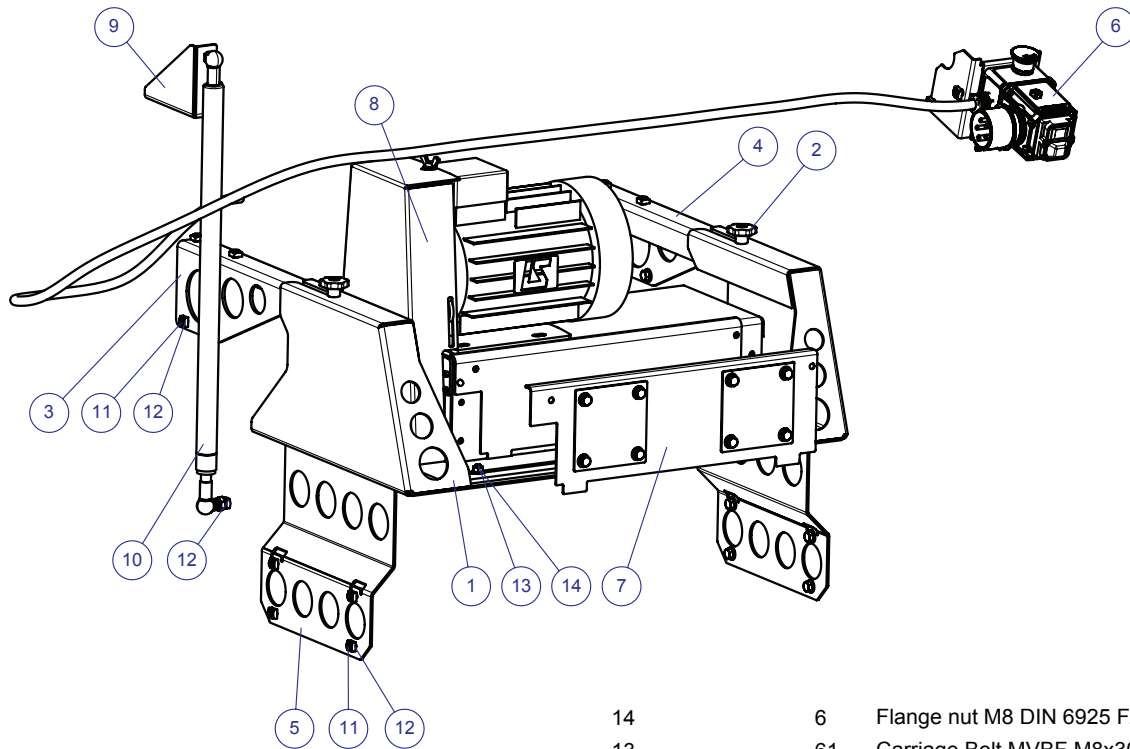

14		6	Flange nut M8 DIN 6925 Fzb
13		61	Carriage Bolt MVBF M8x30 DIN603 Fzb
12		17	Square nut M4M M8 DIN 557 Fzb
11		16	Flange screw M6SF M8x14 DIN 6921 Fzb
10	04-00824	11	Lesjöfors 61604. 500MM, 350NM,M8
9	03-04185	11	Gas spring bracket LH
81	-063-103	1	Fråshuvud
7	01-01261	11	Lid LM410_B701
6	01-01260	11	Control panel
5	03-04176	21	Park position bracket
4	03-04175	11	Bracket right
3	03-04174	11	Bracket left
2	04-00695	21	Stjärnvred WN175 T 40-M8X20
1	03-04173	11	Adapter bracket LM410/B701
Pos.	Art.no.	Qty.	Description
			Iss.

SAFETY INSTRUCTIONS

KEY TO SYMBOLS



WARNING! This symbol means that you have to take particular care. It is always accompanied by information on the specific risk.



ATTENTION. A warning comes after this symbol. Pay particular attention where this symbol appears in the manual text.



For your own safety and the safety of others, do not use the machine without first reading and understanding the entire contents of this user manual.



WARNING! Cutting knives: Careless use of the machine can result in potentially fatal injuries. Planing knives are extremely sharp and dangerous.



Risk of cuts when handling planing knives. Planing knives and motor parts may be hot after cutting. Always wear protective gloves (class 1) when working with the planer or handling planing knives.



Always wear approved ear protection when working with the machine. Even brief exposure to high frequency noise can damage your hearing. Always use close-fitting protective eyewear when working with the machine.



Always wear approved safety shoes with saw protection, steel caps and non-slip soles when working with the machine.



Always wear full-length protective trousers when working with the machine or handling planing knives. Never wear loose-fitting clothing, scarves, necklaces, etc. that may get stuck in the machine when working. Tie back long hair before working with the machine.

SAFETY EQUIPMENT



WARNING! Never use the machine with defective safety equipment.



The safety equipment must be checked and maintained.

OPERATOR











WARNING! When operating the machine, approved personal protective equipment must always be used.



Never use the machine if you are tired, have consumed alcohol or are taking medicine that might affect your sight, judgment or control over your body

SAFETY INSTRUCTIONS

USE

-  **WARNING!** Cutting knives: The planer can cause serious bodily injury if improperly used
-  **WARNING!** Cutting knives: Never insert hands or knives into the machine during operation.
-  **WARNING!** Risk of crushing. Never stand in the path of a board. The board can be thrown back out of the machine. Chips, knots and steel fragments can also be ejected at high speed.
-  **WARNING!** Never modify this machine so that it no longer conforms to the original configuration. Use only LOGOSOL manufactured products or those expressly approved by LOGOSOL for the purpose when adding extra equipment.
-  **WARNING!** Risk of ejection. Never stand in the path of a board. There is a risk of the board being thrown back out of the machine. Knots, splinters or pieces of metal can also be ejected at high speed.
-  Always stand to the side of the work table when operating.
-  The object fed into the machine must have a length of at least 600 mm to prevent the workpiece from twisting between the feed rollers and getting stuck in the machine.
-  Make sure that the machine has been properly assembled and maintained in line with the assembly instructions and maintenance instructions in this user manual.
-  Never work alone. Always make sure there is another adult within hearing distance in case you need to call for help.

BEFORE EACH USE:

Check that:

- The operator is wearing the prescribed personal protective equipment.
- The prescribed maintenance has been carried out.
- The machine has been set up so that it is stable and has support along its entire length.
- Everything on the planer is properly tightened and is in proper working order.
- All the safety equipment on the machine is in place and in proper working order.

Before starting the machine:

- Make sure that no one other than the operator is in the risk zone.
- Check that the cutters can rotate freely and that no knives or unattached parts have been left in the machine.
- Check that all knobs, screws, nuts, bolts, guides, cutter wedges, cutters, knives, protective covers, in-feed and out-feed tables, etc. are properly tightened.
- Check that the cover is properly closed, that all chip couplings are fitted and the chip extractor is switched on.

CHIP COLLECTION

The machine can be connected to a chip extractor with a capacity of at least 2500 m³/h. Remember that you must have an air outlet in your chip container (e.g. a fine net or filter if you have chip collection indoors). Poor suction is often due to poor airflow from the chip container. If you are working in a heated room, keep in mind that the collector will quickly cool the room if the air is not returned. Fire risks and chip emissions associated with chip collection must be taken into consideration.

Fire risk and chip emissions associated with chip collection.



Contact the local authorities for advice on the applicable local regulations.

Connect the chip hoses and secure them with hose clamps to both the planer and the chip extractor. Use Flexi hose from Logosol for best results.

If you want to transport the chips a longer distance: Place the extractor near the planer, so that the hoses are as short as possible. Collect the chips through a sheet metal pipe that has lower airflow resistance.

Position the chip extractor so that its switch is easily accessible.

SETTING UP

WARNING! The layout of the workplace is important for safety. Please note the following:

Choose a location for the machine with a hard and flat surface. Set up the machine on a flat surface with at least 5 m of free space around the machine without obstacles.

Operation of the planer requires proper work lighting.

Keep the workplace free of debris, pets, children, obstacles and anything else that may distract the operator.

Always have a hand-held, ABC type (min. 3 kg) fire extinguisher readily accessible at the workplace.

Always have a complete first aid kit accessible at the workplace.

CONTROL PANEL

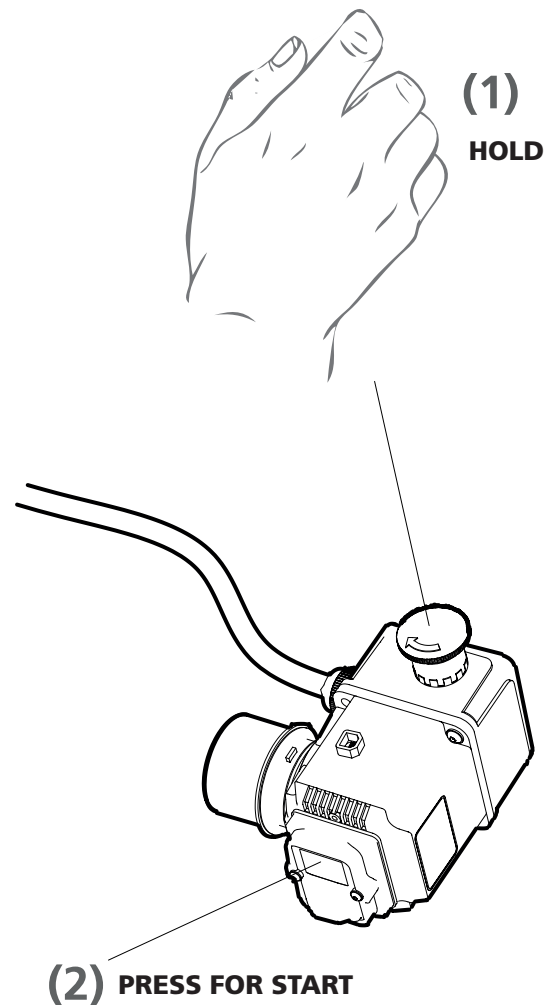

SCREWS/BOLTS/NUTS/WASHERS

Definition of fasteners.

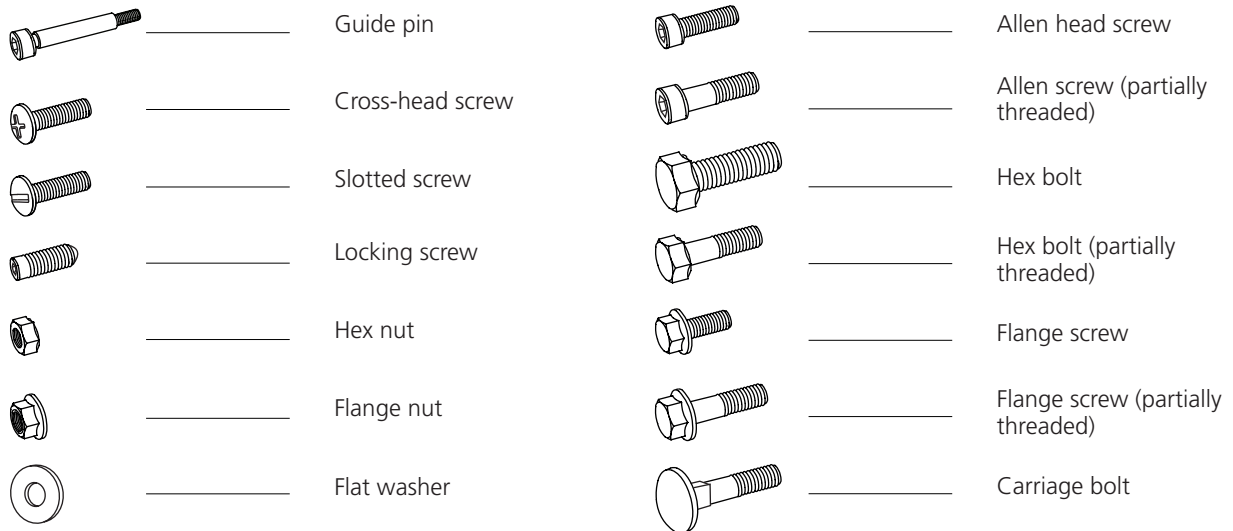

ADDITIONAL SYMBOLS

The following symbols are used in addition to those shown above to describe part design.



DIMENSIONS/LENGTH

The dimensions of the fasteners are printed as a diameter dimension **(M)** ISO 68-1. This is followed by a length dimensions for bolts/screws; the dimension of a bolt/screw is the part of the bolt/screw that disappears into the material in which it is mounted.

(Diameter)		(Length)
M8	x	20

1

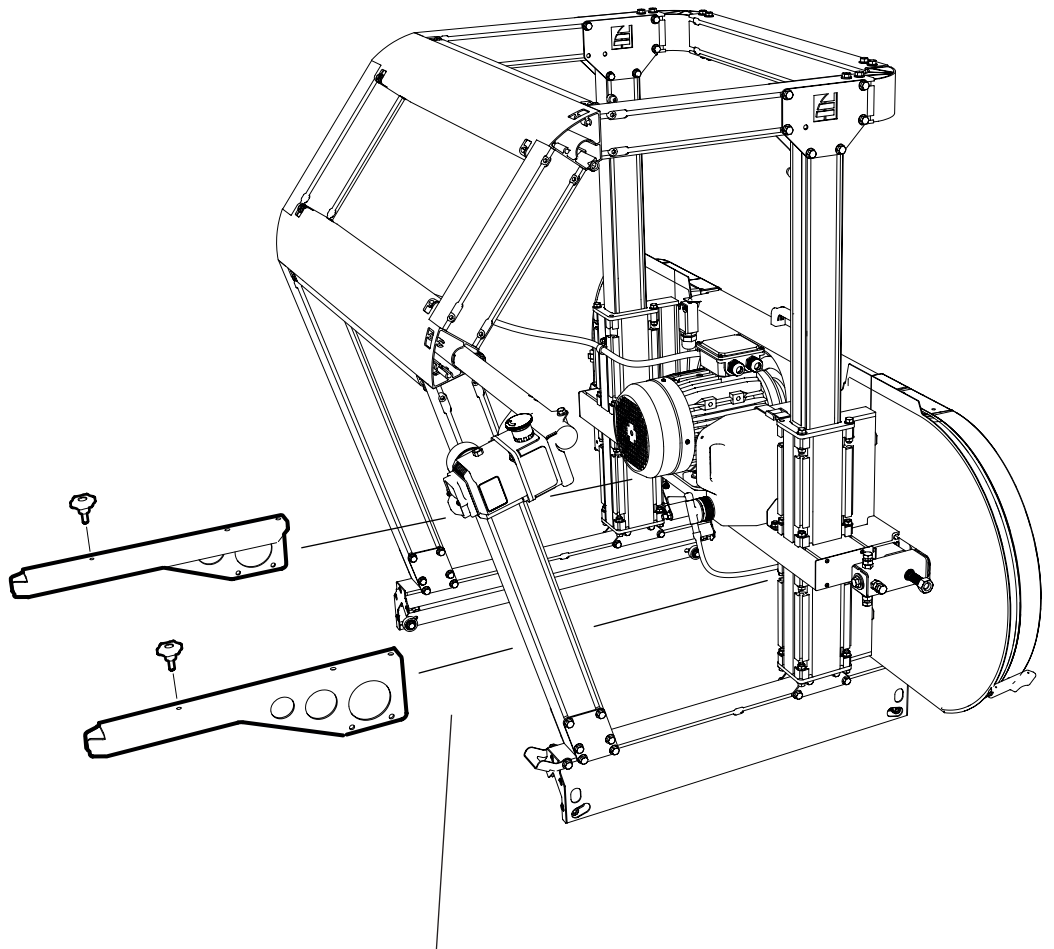

2



8 x - M8x14



8 x

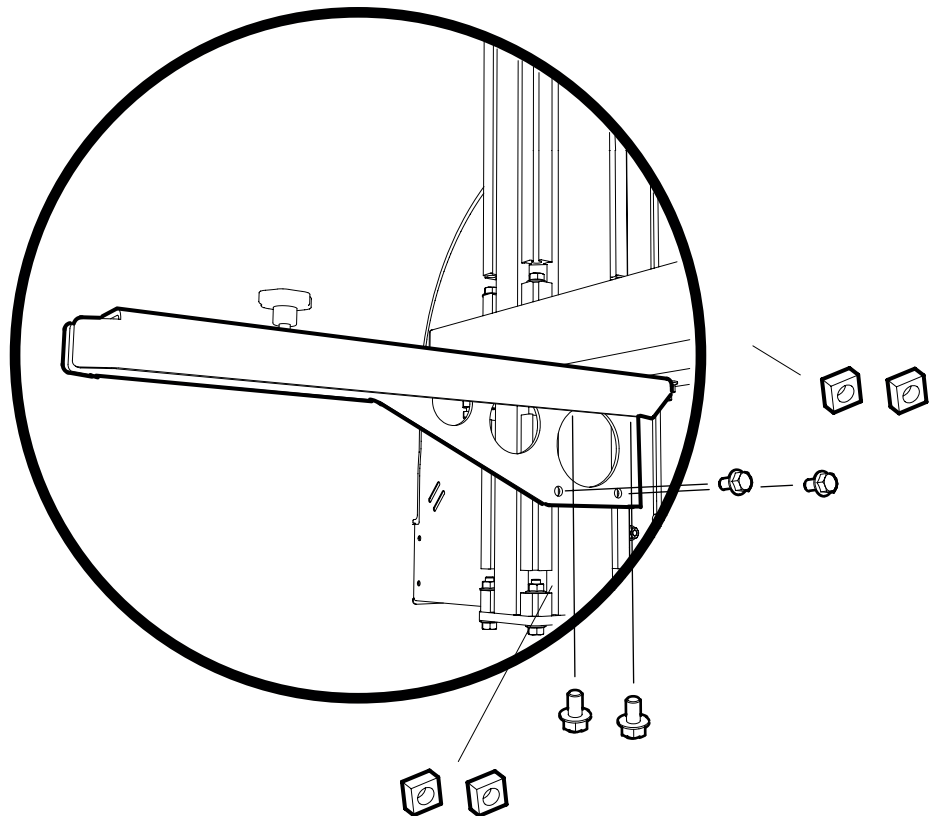

3

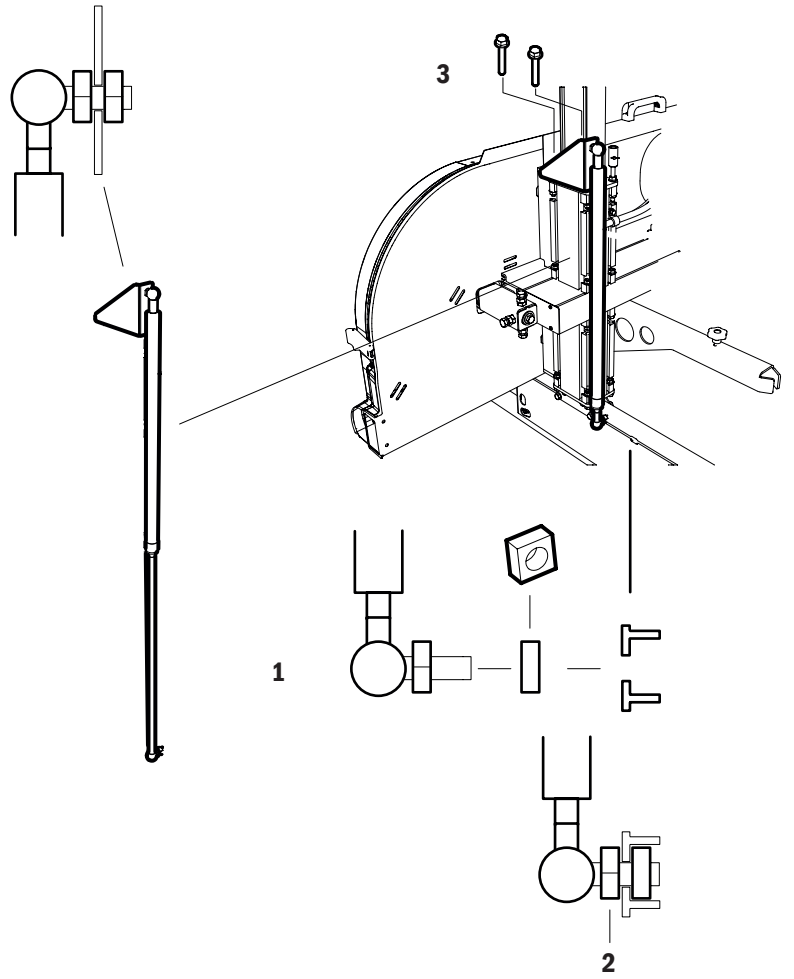

4

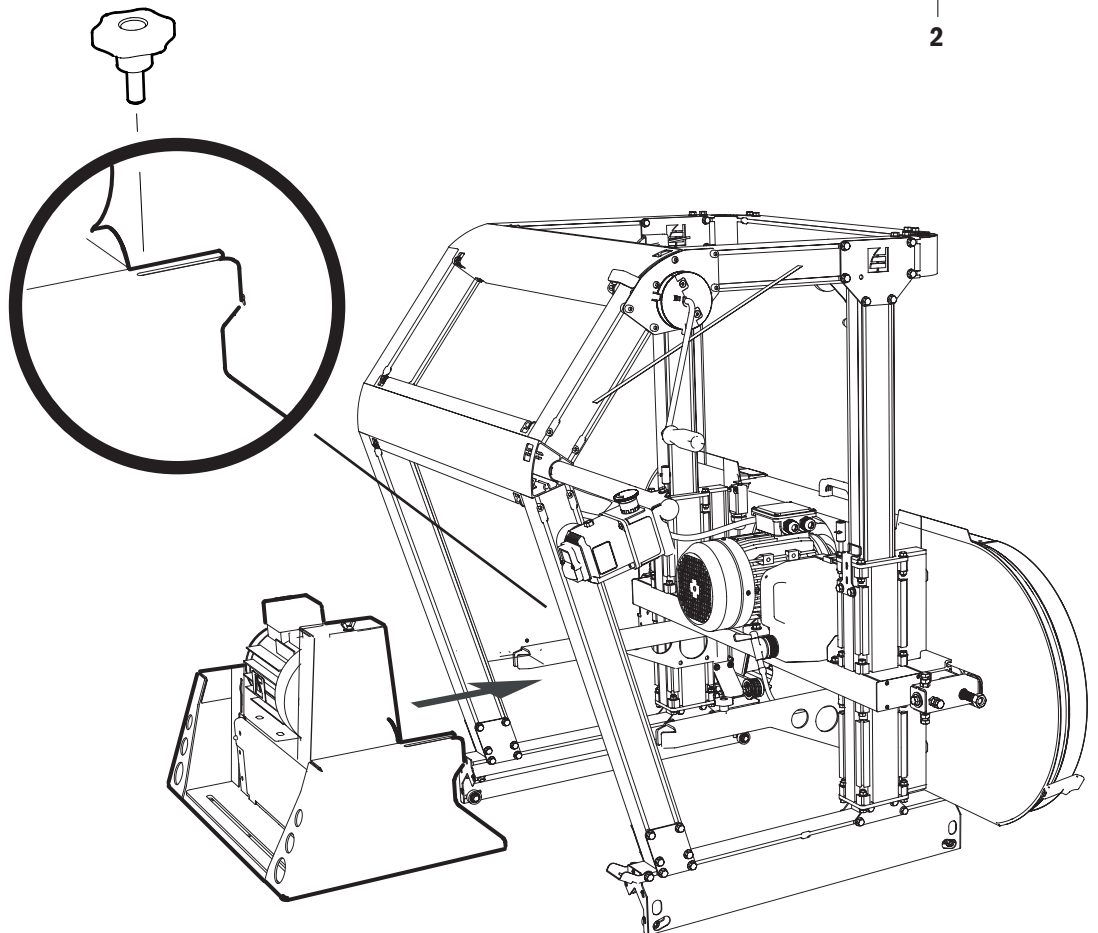

5

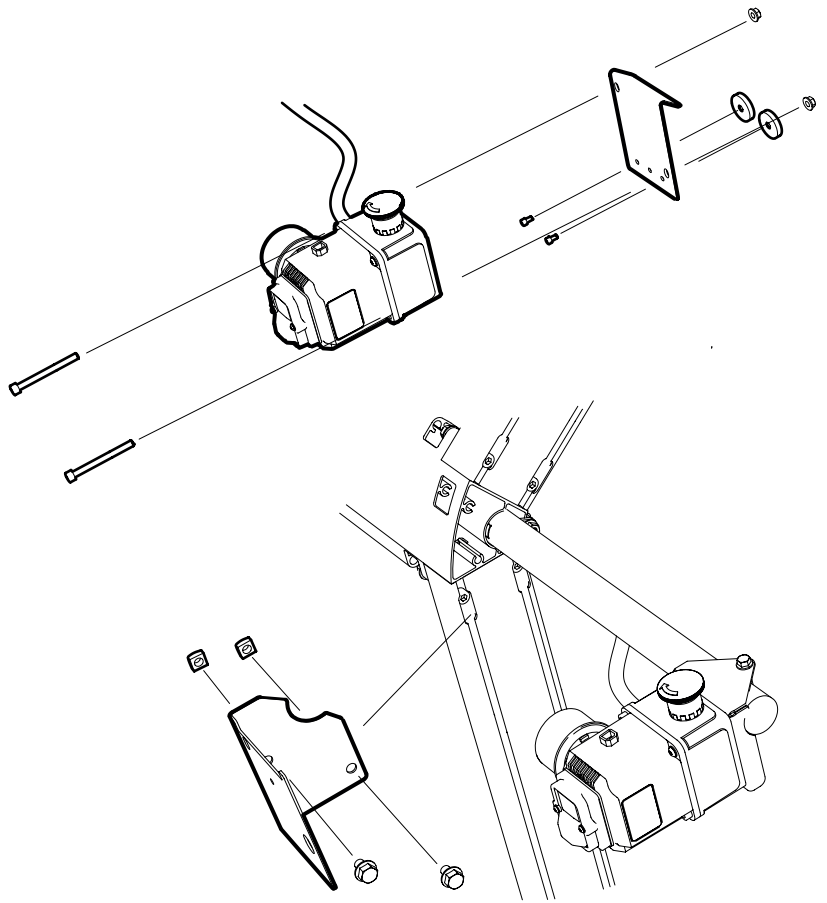

6



8 x - M8x14



8 x

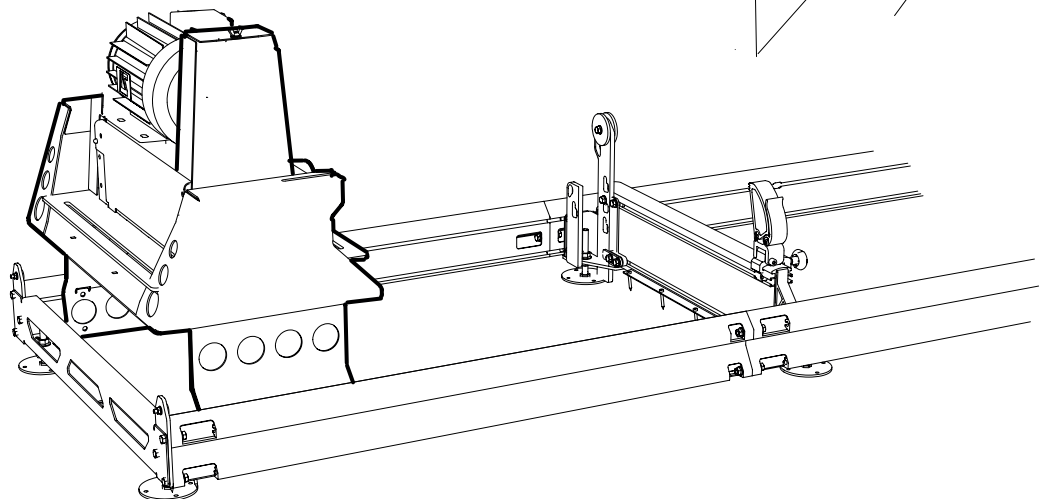
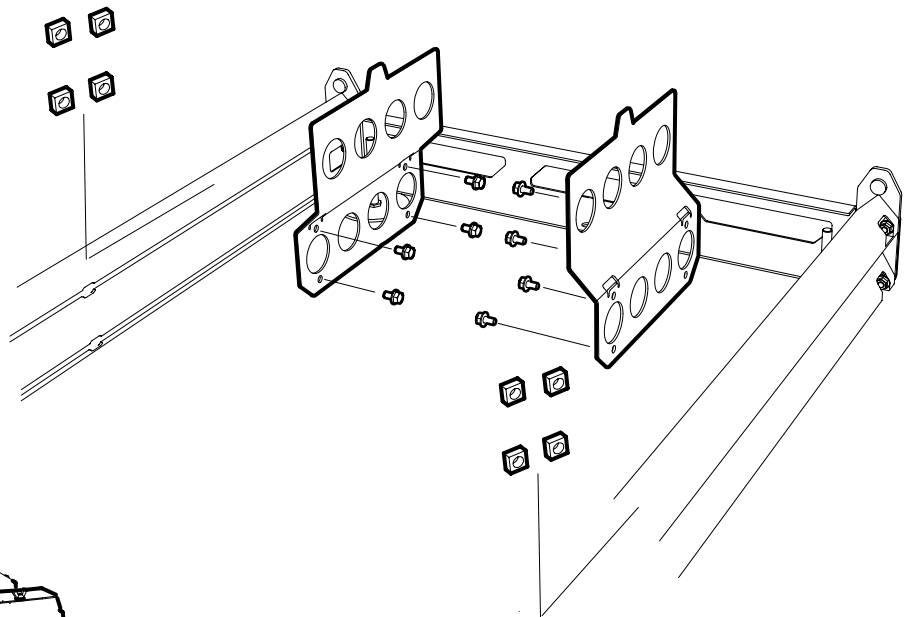

ASSEMBLY: MOULDING KNIVES

ⓘ Before opening the safety cover on the log planer, ensure that the power is switched off and that the cutter is not rotating. Wear protective gloves, particularly when loosening tight screws or when tightening them. Take great care with the planing knives. It is very easy to cut yourself on these, even with the slightest touch.

The moulding knives must always be fitted in pairs, opposite each other. However, a slight lateral offset of the blades is acceptable, provided the cutter remains balanced.

Assembly

- Fit the wedge and the channel section together.
- Insert the wedge and the channel section into the side of the cutter where the wedge slot is open.
- Slide the channel section and the wedge into the slot and secure them by tightening the screw on the back of the wedge firmly.

⚠ An imbalance in the cutter causes vibrations that can damage the machine and result in personal injury.

ⓘ The profile bars must always be fitted in pairs to ensure that the cutter remains balanced. Two identical bars must always be fitted on opposite sides of the cutter.

⚠ There is a risk of serious injury if the steel parts or wedges come loose or break.

ⓘ Steel parts, wedges and cutters must be completely clean when fitted. Replace any damaged steel parts or wedges immediately.

ⓘ The locking screw on the cutter wedges must not protrude beyond the recess in the cutter's wedge groove. Nor must the cutter wedges protrude beyond the cutter. If any wedge is positioned incorrectly, move the entire milling head and start the blade adjustment process again.

After fitting the profile moulding knives

- ⓘ Check that there are no tools left in or on the machine, or on the workpiece to be machined.
- ⓘ Check that all screws are securely tightened.
- ⓘ Check that the cutter can rotate freely before closing the safety cover.

Delicate profiles

The longer and narrower the overhang of a steel, the more careful you must be when using it. Not all profiles can necessarily withstand the same feed rate. Take particular care when milling hard or knotty woods. A bit of common sense is required here, but a rule of thumb is that if the projection is approximately 2:1 (e.g. a 10 mm wide groove that is 20 mm deep), the cutter is very fragile and must be used with great care to avoid breaking. Overhangs of around 1:1 require some caution, whilst cutters with a ratio of less than 1:2 (e.g. a 10 mm wide groove that is 5 mm deep) can be used quite aggressively.

Sharpen the cutter before it becomes blunt

NOTE: Dull blades increase the risk of the blade breaking and thus also the risk of personal injury! If you sharpen the blade before it becomes blunt, sharpening is much easier. The cutting edge suffers significant damage when used while blunt, partly due to heat build-up. If you notice that the blade is blunt, e.g. if the surface deteriorates, you must stop work immediately.

Print marks

Light-coloured marks may sometimes appear on the planed surface. These are pressure marks caused by wood shavings settling on the blade's cutting edge and becoming trapped between the planed timber and the back of the cutting edge. This is usually because the blades are becoming blunt, but it may also be due to the type of timber being planed or the chip extractor not having sufficient capacity.

HORIZONTAL CUTTER HEAD - PLANER KNIVES

Before opening the safety hatch on the planer, make sure that the power is off and that the cutters are not rotating. Wear protective gloves, especially when loosening tight-fitting bolts/screws or when tightening bolts/screws (see Safety precautions). Pay special attention to the planer knives. It is very easy to cut yourself even with a light touch.

The top cutter is fitted in the chassis and suspended at both ends. Two planer knives are mounted in two of the top cutter's keyways on delivery. Two additional planer knives, or moulding knives, can be mounted in the two empty keyways.

The horizontal cutterblock is fitted with 1 pair of planer knives.

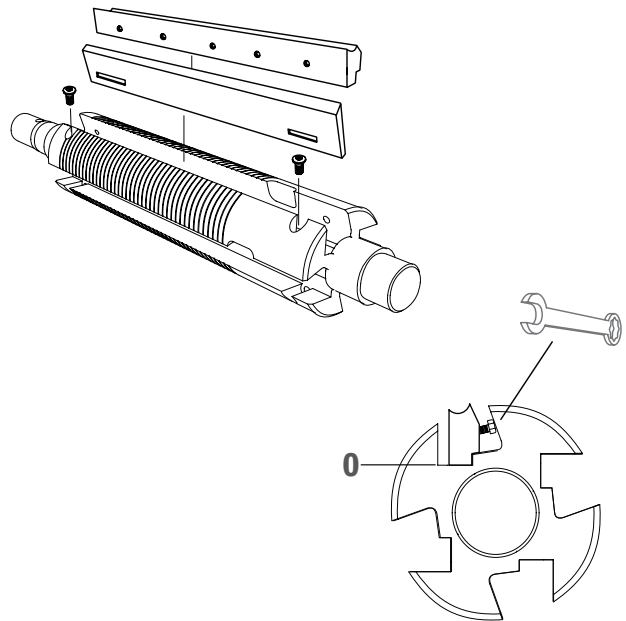

THE SCALE

When the planning knives are fitted to the cutter, their edge is 12.5 mm below the saw blade. The distance between the shelf and the projection of the planning knives can be read from the lower edge of the window on the indicator.

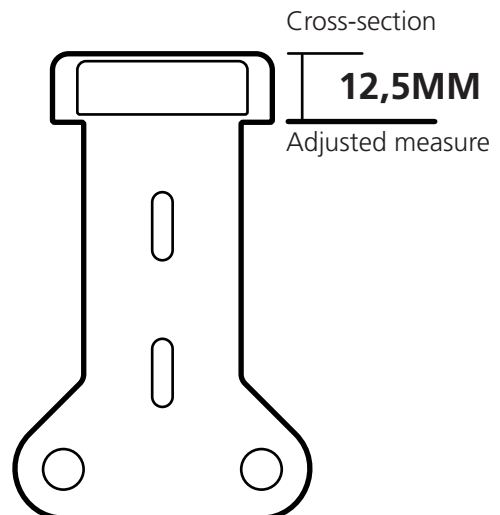

MOUNTING OF MOULDING KNIVES

Mounting moulding knives in the top cutter

In the two keyways without planing knives, moulding knives of different sizes and shapes can be mounted. Wedge and moulding knife assembly: Insert the wedge and moulding knife into the cutter where the keyway widens. Check that the wedge is at the bottom of the milled slot in the cutter.

Secure the knife by firmly unscrewing the locking screw on the back of the wedge.

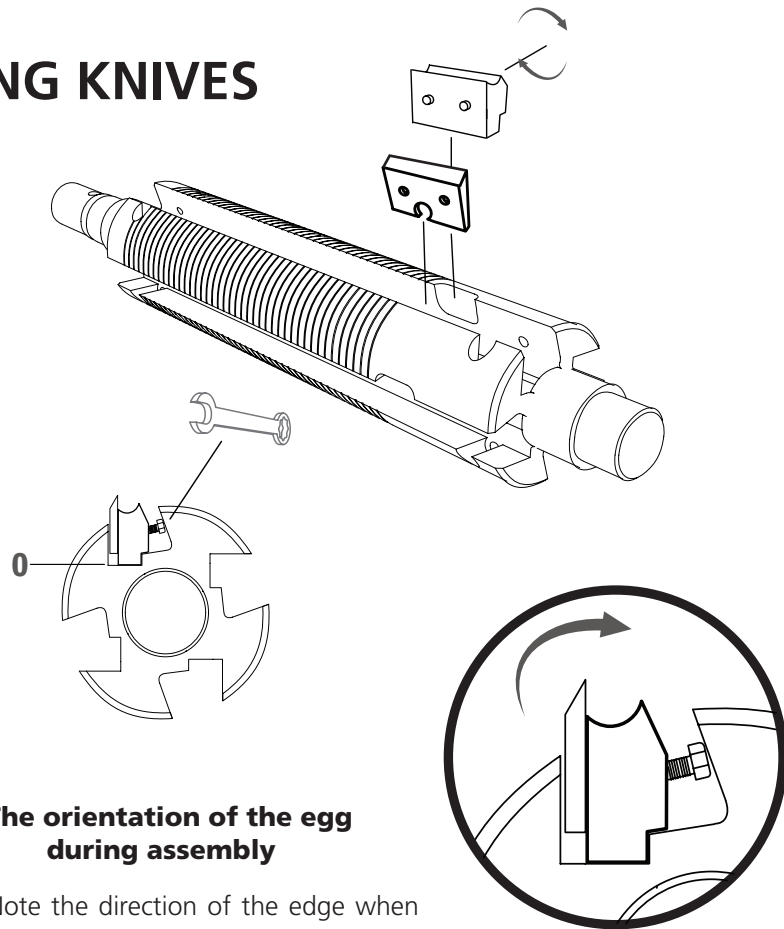

The orientation of the egg during assembly

Note the direction of the edge when fitting the knives to the cutter

Steel kits for timber-framed houses

Fit the moulding knives to machine one side of the block so that the assembly is symmetrical. Then repeat the assembly process for the second set of steel knives. Fit the moulding knives into the grooves that do not have planing knives fitted. Note that the knives must always be fitted so that the cutters are loaded symmetrically.

Secure the knives by tightening the locking screw on the back of the wedge firmly.

LOG SUPPORT

The edge of the cutter is set back 98.5 mm from the normal position of the log support. Fit the brackets so that the log support can be mounted 98.5 mm inside the original position. To be able to mount the other side of the block, then fit additional mounting points so that the log support is 410 mm further in. Note that the mounting must be mirror-inverted.

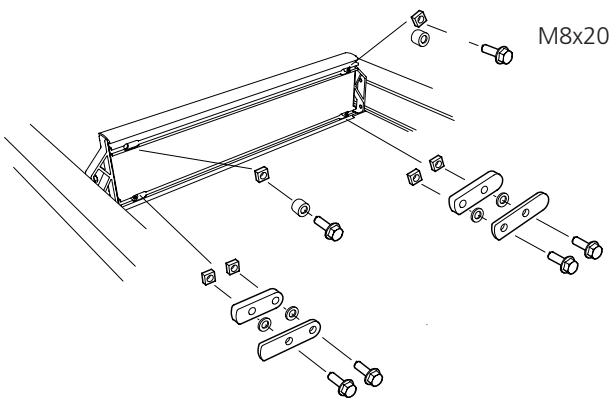

4 x – M8x25

2 x – M8x20

6 x – M8

4 x – M8

2 x – 03-04019

2 x – 03-04018

2 x – 9291-020-0005

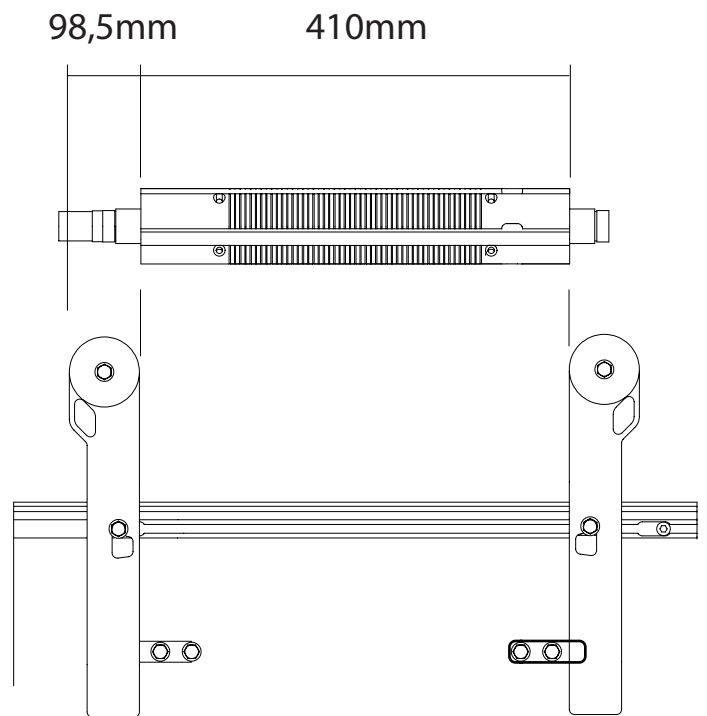
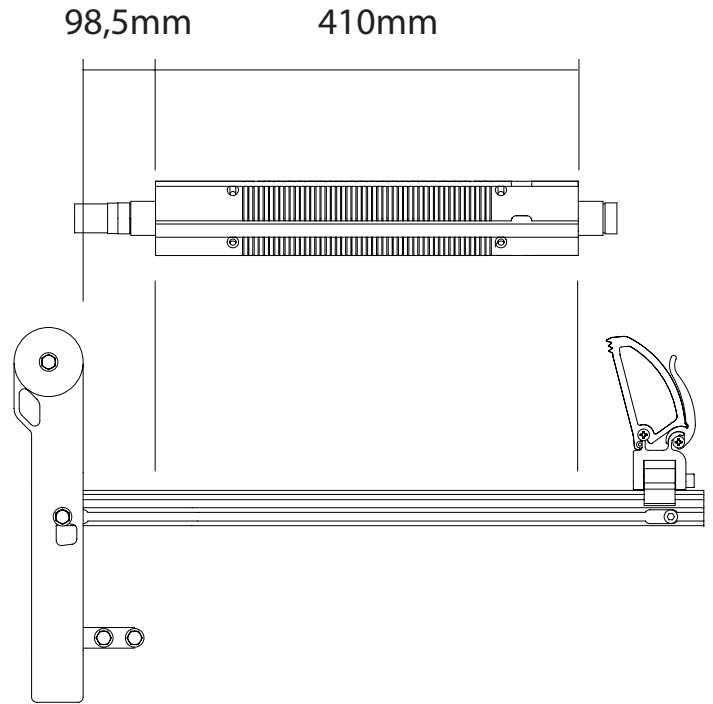

Adjust the planing knives so that they reach the same level and have a one millimetre protrusion. This is most easily done using Logosol's aluminium adjustment block.

Slightly loosen the locking screws on the wedge, and slide the adjustment block over the knife. Adjust the knife up or down with the adjusting screws until the knife touches the block when it is moved over the knife. (The planer knives protrusion can also be adjusted with Logosol's magnetic setting for the top cutter.

- ❗ Securely tighten the planing knives using the locking screws on the wedge when the adjustment is complete. Then screw the adjustment screws all the way down.
- ❗ When the cutter's bearing housing has been adjusted, or when planer knives degree of removal has changed, the position of the rotating scale must be calibrated. The indicator on the height scale on the front of the machine may also need to be adjusted.

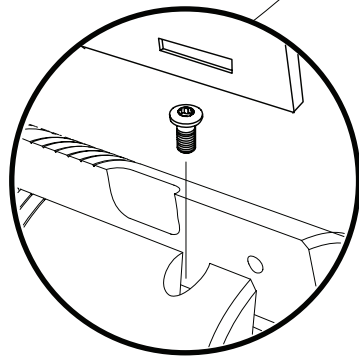

Planer knife adjustment screws

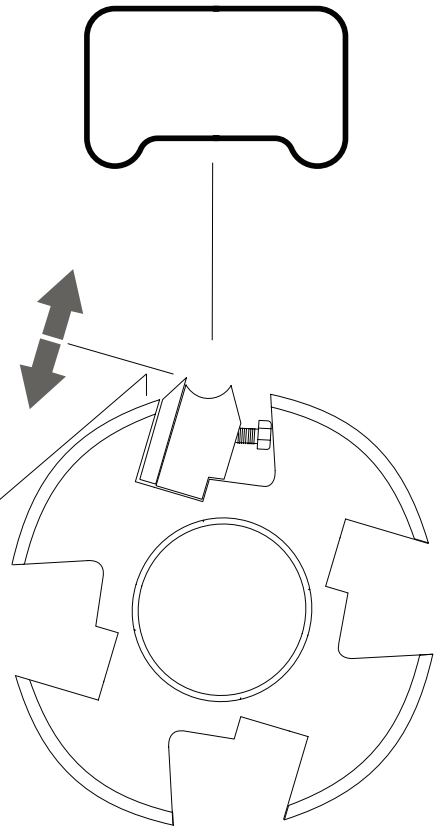

Adjustment screws for planing knives

After adjusting or replacing planer knives:

- ❗ Check that no knives have been left in the machine.
- ❗ Check that all screws/bolts are securely tightened.
- ❗ Check that the cutters can rotate freely before closing the safety hatch.

MAINTENANCE

MAINTENANCE

The periodic maintenance of the machine that is expected to be performed by the operator is described in this section. Be sure to follow the specified maintenance intervals, as this is the basis for good function of the planer.

The machine is easy to maintain, as it is largely rust-proof. All cutter bearings and the motor are completely maintenance-free. The maintenance required is listed below.

 Make sure the power is switched off before opening the access panel to the cutter or removing any protective cover.

Tip: It is a very good idea to use compressed air to blow the machine clean every time you open the safety cover. Wear ear protectors and safety goggles.

When the machine is in use

- Clean the machine of wood shavings after each use. Take particular care to ensure that no shavings have accumulated on the motor or in the motor cooling fan. If this happens, it may prevent the motor from cooling properly and lead to motor failure or, in the worst case, a fire.

After each shift

- Remove loose shavings and dust using a soft brush or compressed air (in which case, wear ear protectors and safety goggles). Also check the shavings hoppers and hoses.

- Cleaning and rust protection using Universal Oil 9999-000-5105: Dried-on sawdust and resin can be removed with universal oil. Also spray a thin layer onto the cutter, cutter blades and the wheel suspension's ball bearings to protect against rust. Avoid getting large amounts of oil on the belt drive. When replacing blades or repositioning existing blades, the cutter's keyway, cutter keys and the knives must be cleaned very thoroughly. Even the smallest chip on any of the knives' contact surfaces can lead to total failure and a risk of personal injury as the knives shatter.



WARNING! Risk of serious injury:



Before performing service and maintenance on the machine: Make sure that the powercord is disconnected from the machine.



WARNING! Lacerations:



Planer knives are extremely sharp and there is a risk of cuts even with a light touch; always use gloves when working inside the machine.

- Checking the safety switch on the cover: Switch off the power and check that the safety switch on the router head is working. The switch must be clean and its button must move freely. (The machine must not be able to start when the cover is open.)

If the machine is not to be used for a prolonged period

- Disconnect the power supply.

- Clean the entire machine thoroughly, and carry out the same maintenance as after every working shift. Do not forget the lubrication points.

- Remove the cutter blades and cutter wedges. Store these well-oiled and at room temperature.

- Position the machine so that it is not in contact with the ground and cover it with a tarpaulin.

Before starting up after prolonged storage

Condensation may collect in the motor and in the control panel after prolonged storage in a cold environment. The motor has a drain plug on the underside. Open this and drain out any water. Open the control panel and wipe away any accumulated water.

MILLING OF TIMBER

This section describes the profiling of 150 mm wide timber (approx. 6 inches) at the sawmill. The principle is the same for other widths and profiles, even though the dimensions differ.

Cut a block

Cut a block to the width you intend to use for log construction, in this case 150 mm. The block may be tapered or of uniform thickness.

Fit the moulding knives into the cutterblock

The cutter on the router is 410 mm wide.

On one half, fit the knives for rounding the timber block only. On the other half, fit the knives for rounding and long cuts.

Fit the moulding knives so that the centre of the entire profile aligns with the centre of the sawn block, in this case 75 mm from the stop.

Route the block.

Move the clamp and turn the block

Once one side has been profiled, move the clamp to the other side.

Then turn the block towards the clamp and secure it.

Check and adjust the moulding knives so that the centre of the profile aligns with the centre of the block.

Mill the block.

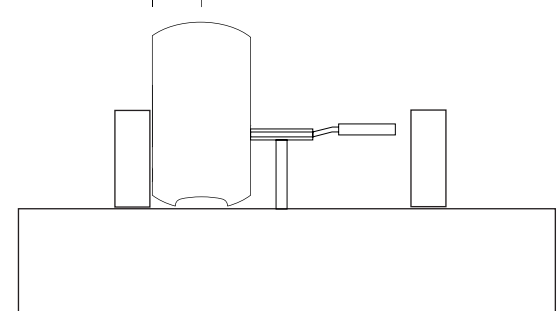
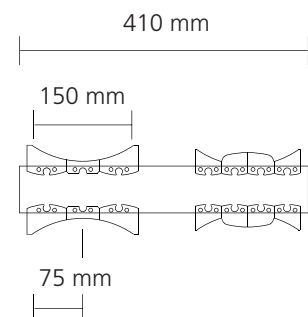
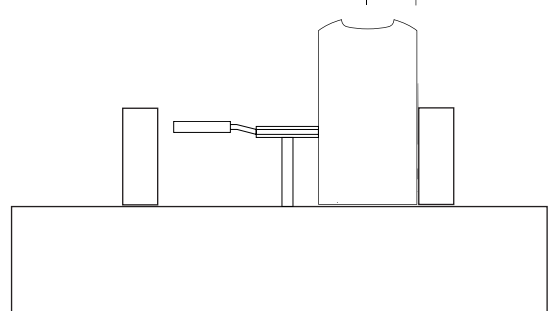
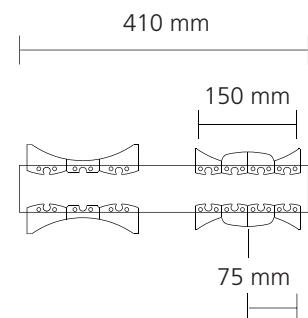
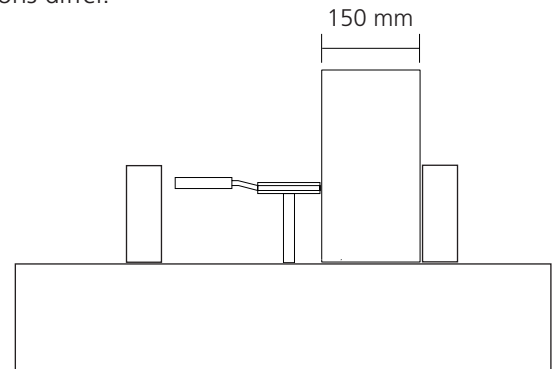

TROUBLESHOOTING

Problem	Possible cause	Action
Lines along the edges of the moulding knives.	<ol style="list-style-type: none"> 1. The planer knives are set to remove to little material. 2. The moulding knives have been incorrectly sharpened. 	<ol style="list-style-type: none"> 1. Adjust planer knife removal with Logosol's adjustment block or with magnetic adjustment for the top cutter to 1 mm or, if necessary, a few tenths of a millimetre more. 2. Grind the moulding knives so that their edges are below the level of the planer knives, or use adjustable moulding knife wedges and position the moulding knives correctly against the planing knives.
The planer knives planes down the moulding's highest points.	<ol style="list-style-type: none"> 1. The planer knives are set to remove to much material. 2. The moulding knives have been incorrectly sharpened. 	<ol style="list-style-type: none"> 1. Adjust planer knife removal with Logosol's adjustment block or with Logosol's magnetic setting for the top cutter to 1 mm or a few tenths of a millimetre less. 2. Use Logosol's adjustable moulding knife wedges and position the moulding knives correctly against the planer knives.
The width of the board changes during processing.	<ol style="list-style-type: none"> 1. The workpiece moves away from either the in-feed or out-feed fence. 2. The locking screw of the movable cutter is not tightened. 3. Pressure plates, spring mechanism jams. 4. The workpiece is too small for the set planer dimensions. 5. Excessive removal at the fixed side cutter. 	<ol style="list-style-type: none"> 1. The outfeed fence are incorrectly set. Adjust the in/outfeed fences correctly. 2. Tighten the screw before planing. 3. Adjust the spring mechanism of the pressure plates. 4. Choose a wider workpiece or reduce the set width. 5. Reduce the feed speed or reduce removal of the fixed side cutters.
Poor surface along the left side of the workpiece.	<ol style="list-style-type: none"> 1. The movable cutter's locking screw is not tightened. 	<ol style="list-style-type: none"> 1. Tighten the screw before planing.
Thin lines that are higher than the rest of the surface on the planed workpiece.	<ol style="list-style-type: none"> 1. The planer knives have had small marks due to grains of sand, gravel, etc. 	<ol style="list-style-type: none"> 2. Move one of the planer knives approximately 1 mm and secure again. In this case, the planer knives slightly overlap each other and the lines can disappear. If the problem persists, the knives need to be sharpened.
Chips are ejected from the workpiece at the movable side cutter.	<ol style="list-style-type: none"> 1. Too much removal. 	<ol style="list-style-type: none"> 1. Sizing plane the workpiece before final processing.

TROUBLESHOOTING

Problem	Possible cause	Action
The engine won't start.	<ol style="list-style-type: none"> 1. The lid is not properly closed. 2. The latches are not engaged. 3. The machine has no power supply. 4. The motor has overheated. 5. Fault in the machine's electrical system. 6. Wood shavings have become lodged in the safety switch on the guard. 	<ol style="list-style-type: none"> 1. Tighten the lid's locking screw. You may hear a faint click when the safety switch engages. 2. Press both hold buttons simultaneously. 3. Check the earth leakage circuit breaker and the fuses in the property, and check the connection cable. 4. Wait until the motor's overheating protection has reset automatically. 5. The electrical system must only be accessed by a qualified electrician: First check the holding circuit. This includes, among other things, the holding solenoids, the safety switch and the overheating protection in the terminal block on the motor. 6. The electrical system must only be accessed by a qualified electrician: Remove and clean the safety switch of any debris.
The cutterblock continues to rotate long after the machine has been switched off (the stop time should be no more than 10 seconds).	<ol style="list-style-type: none"> 1. The strap is too loose 2. The strap is worn out. 	<ol style="list-style-type: none"> 1. Tighten the strap. 2. Replace the strap.
The cutterblock runs for a while but then stops.	<ol style="list-style-type: none"> 1. The engine is overheating. 	<ol style="list-style-type: none"> 1. See the section 'The engine is overheating'.
The engine is overheating.	<ol style="list-style-type: none"> 1. Wood chips have accumulated on the motor and around its cooling fan. 2. Dull knives. 3. Voltage in the power supply is too low. 4. Loose connections or poor contact in the power supply to the machine or in the machine's electrical system. 5. Excessive cutting on the cutter 6. Feed rate is too high. 	<ol style="list-style-type: none"> 1. Clean. Keeping the motor clean ensures more efficient cooling. 2. Sharpen or replace the knives. 3. The electrical system must only be accessed by a qualified electrician: Check that the voltage is correct on all phases and that the connection cable is of the correct rating. 4. The electrical system must only be accessed by a qualified electrician: First and foremost, check that the connection cable has the correct current during operation. Check that all cables are correctly connected to the machine's electrical system and motor. 5. If the workpiece is wide, made of hard wood, or has large or varying over-dimensions: Process the log in several stages and take a little at a time. 6. Reduce the feed rate

Problem	Possible cause	Action
Noise or vibration in the cutter.	<ol style="list-style-type: none"> 1. The moulding knives are fitted incorrectly 2. The moulding knives or planing knives are incorrectly ground. 3. The bearing is faulty. 4. The belt drive is faulty. 	<ol style="list-style-type: none"> 1. Clean the cutter and fit the steel knives and cutter wedges/chip breakers correctly. Identical knives must be fitted on opposite sides of the cutter with no or only a slight lateral offset. 2. Grind the knives in pairs so that they are identical on opposite sides of the cutter 3. Clean the bearing housing and replace the ball bearings. 4. Clean the pulleys and replace the poly-V belt.

TECHNICAL DATA

DIMENSIONS/WEIGHT

Length	400 mm
Height	450 mm
Width	700 mm
Weight	60 kg

ELECTRICAL SYSTEM

Electrical system CEE 16A 400V 50Hz three-phase (alt. 230V three-phase 16A)
Enclosure class IP54.

DIMENSIONS

As planer	
Max. width	410 mm
Height	19 to 470 mm

CUTTER HORIZONTAL CUTTER

Diameter	72 mm
Width	410 mm
Power	4 kW
RPM	6000 RPM



EU declaration of conformity

In accordance with Directive 2006/42/EG, Annex 2A

Logosol AB
Arkivvägen 6
871 53 Härnösand, Sverige

herewith declares that: **LOGOSOL LOG MOULDER 00-00141**

has been manufactured in conformity with the Machinery Directive 2006/42/EG and the EMC Directive 2014/30/EU

and has been manufactured in conformity with the following harmonized standards:
EN ISO 12100:2010, EN 60204-1:2018,
EN 50370-1:2005, EN 50370-2:2003.

The delivered machine corresponds to the machine that was subject to EC type-examination.



Declaration of conformity

Logosol AB,
Fiskaregatan 2,
SE-871 33 Härnösand, Sweden

hereby declares that **Logosol Log Moulder**

has been manufactured in conformity with: Supply of Machinery (Safety) Regulations 2008

and has been manufactured in conformity with the following harmonised standards:
BS EN ISO 12100:2010,
BS EN ISO 19085-1:2021,
BS EN 60204-1:2018

Härnösand 2026-01-12

Robert Berglund

2026-01-12

ROBERT BERGLUND, CEO

LOGOSOL

Arkivvägen 6, SE-871 53 Härnösand, SWEDEN

+ 46 611-182 85 | info@logosol.com

www.logosol.com