

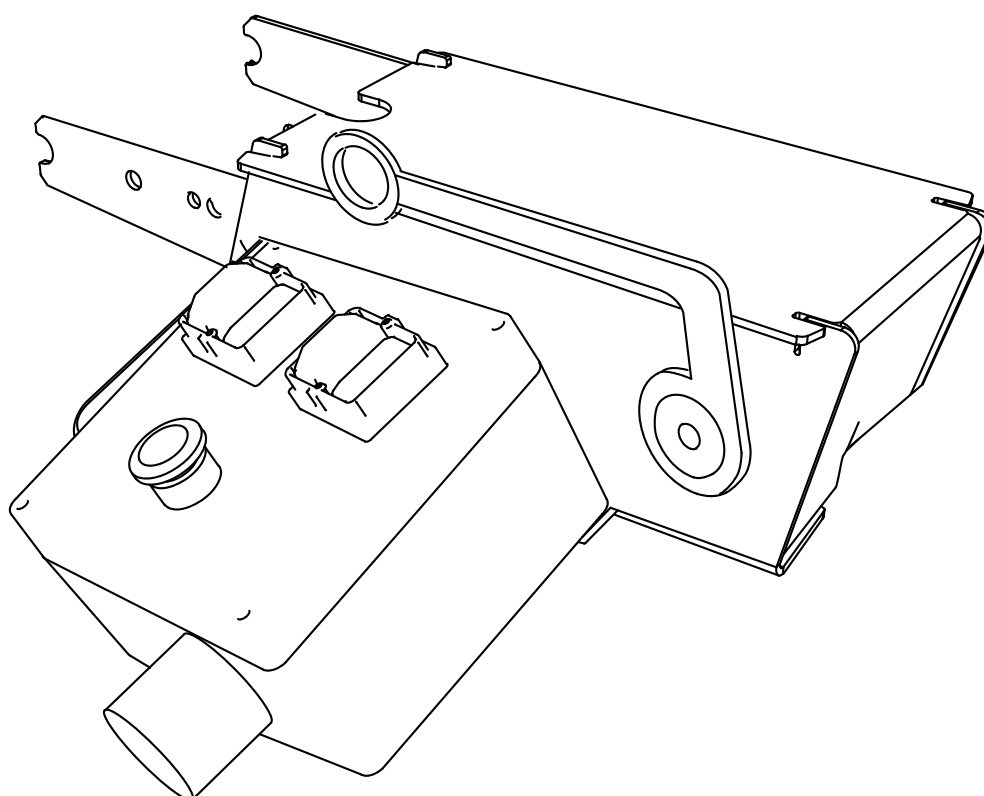

# USER MANUAL

SKU: 0458-395-5611

REV:2



## ELECTRIC REMOTE DRIVE FOR ES5/ES8 400V 50HZ

EN

## THANK YOU FOR CHOOSING A LOGOSOL PRODUCT!

Welcome! We are very pleased that you have demonstrated your confidence in us by purchasing a LOGOSOL product, and we will do our utmost to meet your expectations.

LOGOSOL has been manufacturing sawmills since 1989. In that time we have supplied approximately 50,000 machines to satisfied customers the world over.

We care about your safety as well as we want you to achieve the best possible results with your equipment. We therefore recommend that you take the time to carefully read this user manual from cover to cover in peace and quiet before you begin using the equipment. Remember that the equipment itself is just part of the value of the product. Much of the value is also to be found in the expertise we pass on to you in the user manuals. It would be a pity if that were not utilised.

We hope you get a lot of satisfaction from the use of your new LOGOSOL product.

### **Bengt-Olov Byström**

Founder and chairman,  
Logosol in Härnösand, Sweden



Read through the user manual carefully and make sure you understand its contents before you use the equipment.



This user manual contains important safety instructions.



**WARNING!** Incorrect use can result in serious or fatal injuries to the operator or others.



LOGOSOL continuously develops its products. For this reason, we must reserve the right to modify the configuration and design of our products.

Document: Electric Feed Unit

Ref. No. User Manual, English:

Last revised: June 2025

© 2025 LOGOSOL, Härnösand Sweden



00-00133

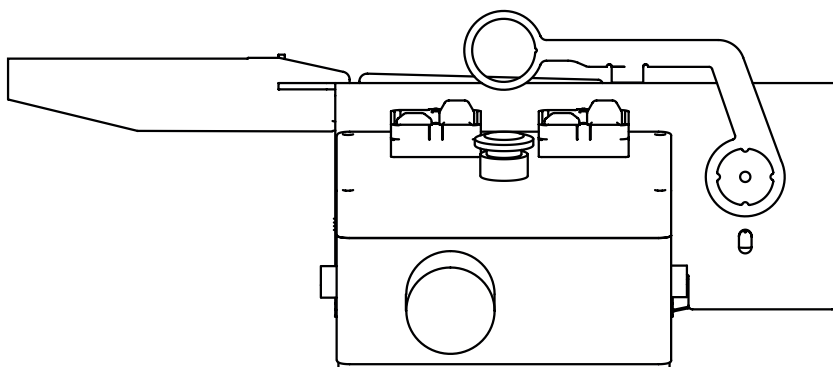

01-0165

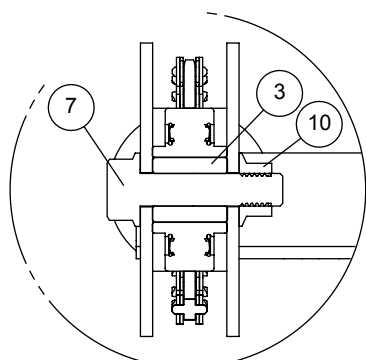
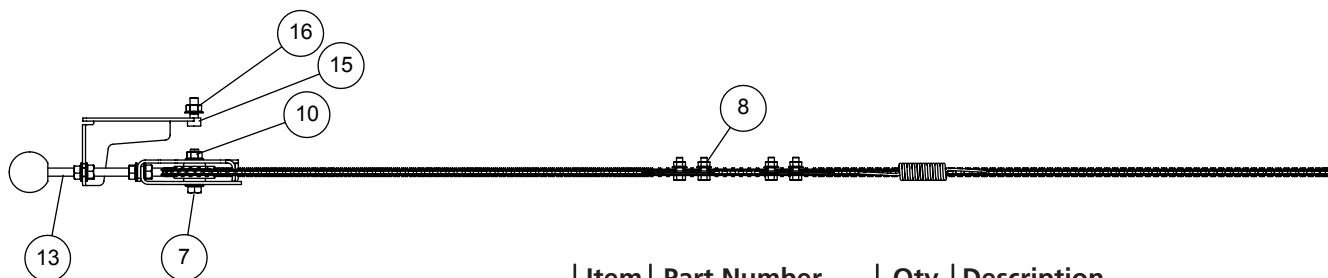
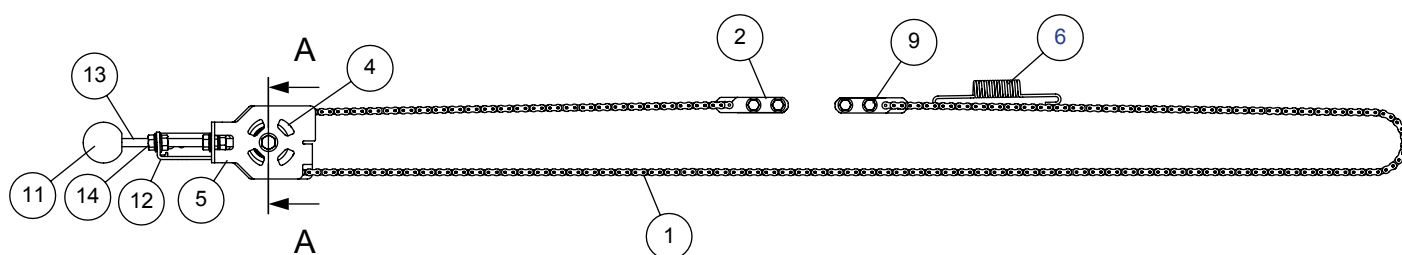

Detail B

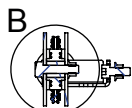

Section A-A

Item No.	Part Number	Qty	Description
16		1	Nut LM6MF M8 8 fzb
15		1	Screw MC6S M8x20 8.8 fzb
14		4	Nut M6MF M8 8 fzb
13	03-03239	1	Threaded rod M8x150 8.8 fzb
12	03-03812	1	Mount Bracket
11	DK-00110	1	Endcap WN319 G32-M8
10		1	Nut LM6MF M8 8 fzb
94			Screw M6SF M6x16 8.8 fzb
84			Nut LM6MF M6 8 fzb
71			Screw M6SF M8x35 fzb 8.8
6	04-00764	1	Spring (N45606-lesjofors)
5	03-03811	1	Turn wheel plate
4	04-00561	1	05B-1 Z=23 Tension sprocket
3	03-03159	1	Spacer D=15,8x8,1 L=18,5
2	03-03157	4	Chainholder
1	01-00697	1	Feed Chain (Manual)

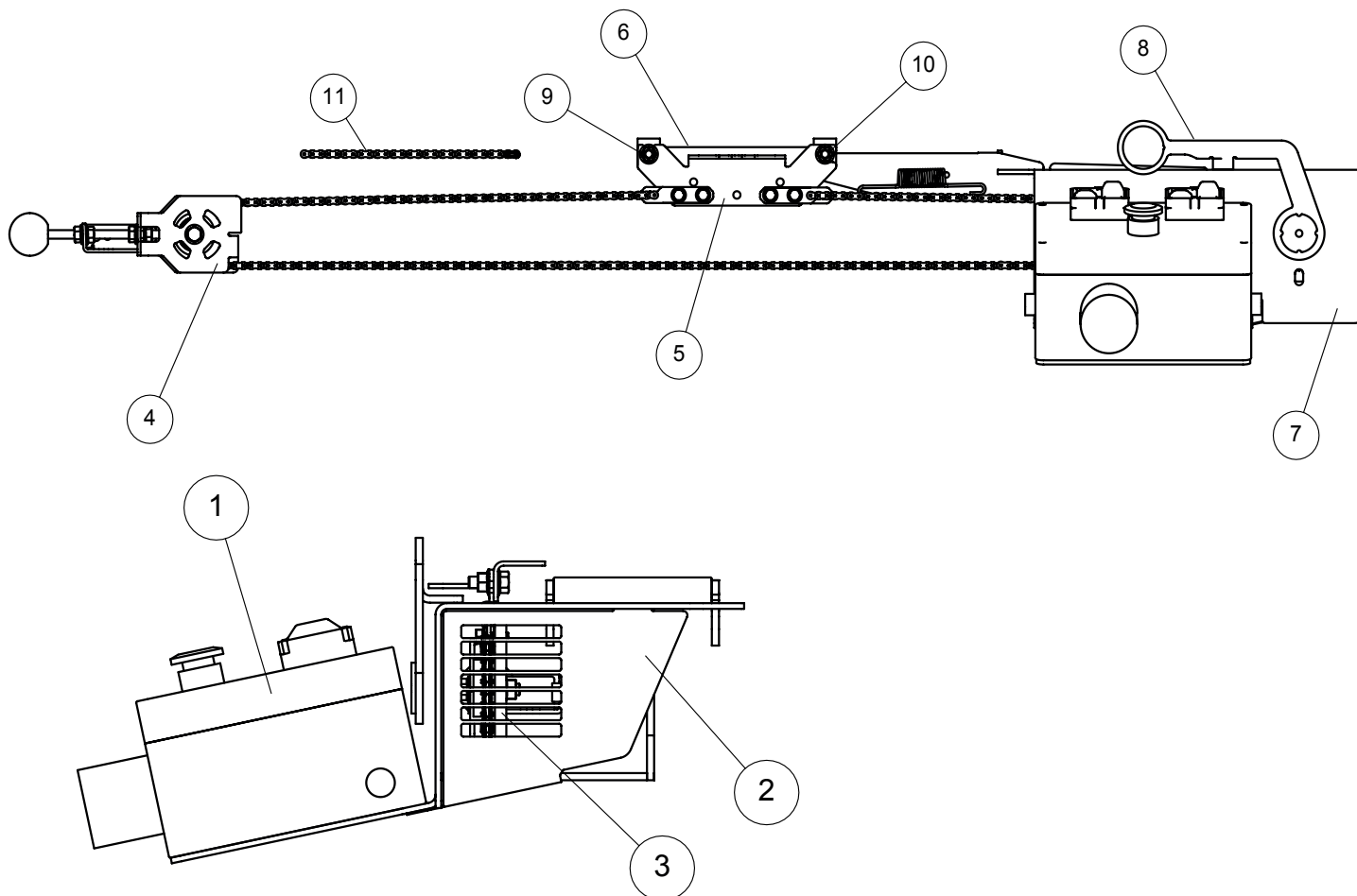

Item No.	Part Number	Qty	Description	Issue
1	8000-001-0505	1	Electric box	1
2	03-03824	1	Cover plate	1
3	02-00584	1	Clutch Pressure plate with sprocket	1
4	01-01065	1	E25 feed chain kit	1
5	03-02797	1	Cable & Wire mount	1
6	03-02796	1	Bracket	2
7	02-00585	1	Loading ramp weld assy	1
8	02-00581	1	Control lever	1
10		2	Nut LM6MF M8 8 fzb	
11	04-00776	1	Chain Extension E25	1
92			Screw M6SF M8x20 8.8 fzb	

## BOLTS/NUTS

Definition of fasteners.

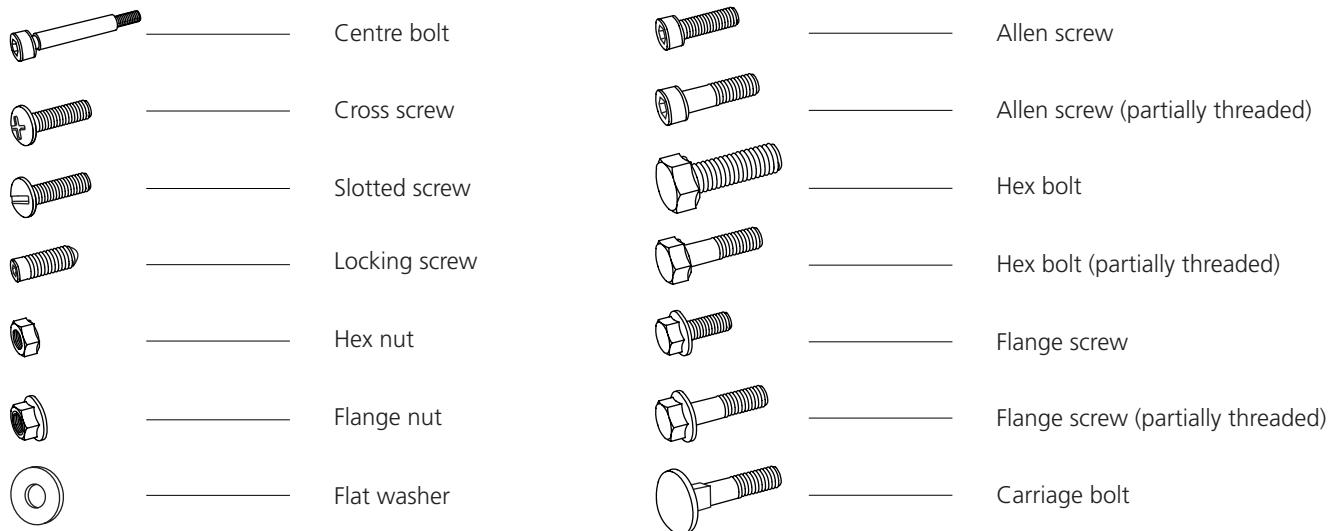

### ADDITIONAL SYMBOLS

The following symbols are used in addition to those shown above to describe part design.



The symbol describes the sawing direction and reappears during assembly.



When this symbol appears during assembly, parts must be lubricated before installation. Lubricate affected parts with universal grease.



The symbol plus a number that refers to packages of hose and nipples.



The symbol describes the recommended lifting point for heavy lifts.



Make the joint finger-tight.



### DIMENSIONS/LENGTH

The dimensions of the fasteners are printed as a diameter dimension (M) ISO 68-1. This is followed by a length dimensions for bolts/screws; the dimension of a bolt/screw is the part of the bolt/screw that disappears into the material in which it is mounted.

(Diameter)		(Length)
M8	x	20



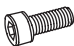

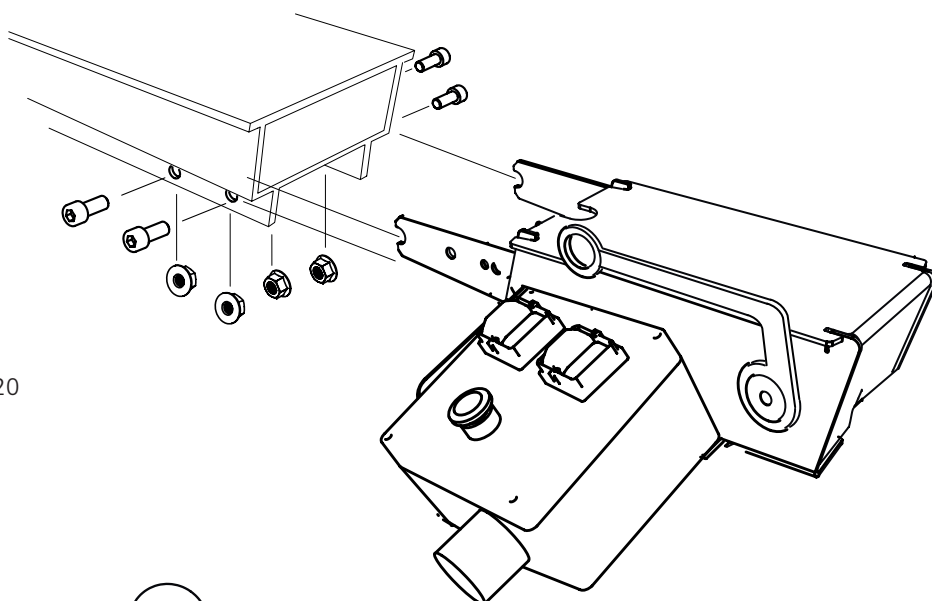

1

-  — 4 x — M8x20
-  — 4 x — M8



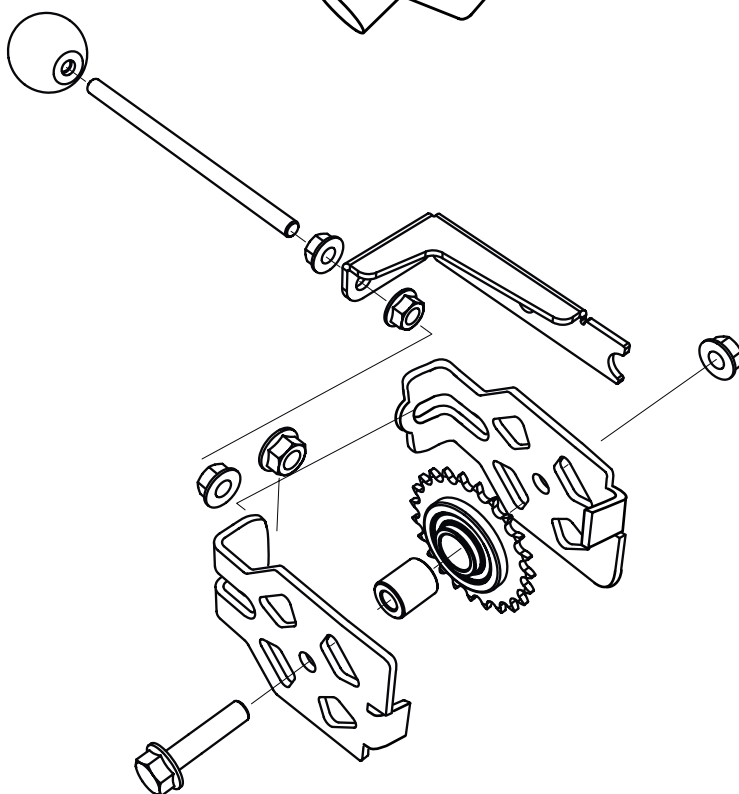

2

-  — 1 x — M8x35
-  — 4 x — M8
-  — 1 x — M8
-  — 1 x — 04-00561
-  — 1 x — 15,8x8,1x18,5



3

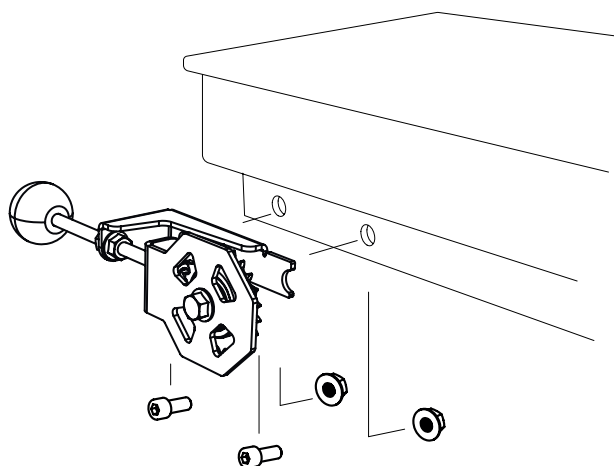

The assembly uses the existing bolts.

-  — 2 x — M8x20
-  — 2 x — M8





4

-  — 2 x — M8x16  
 — 2 x — M8

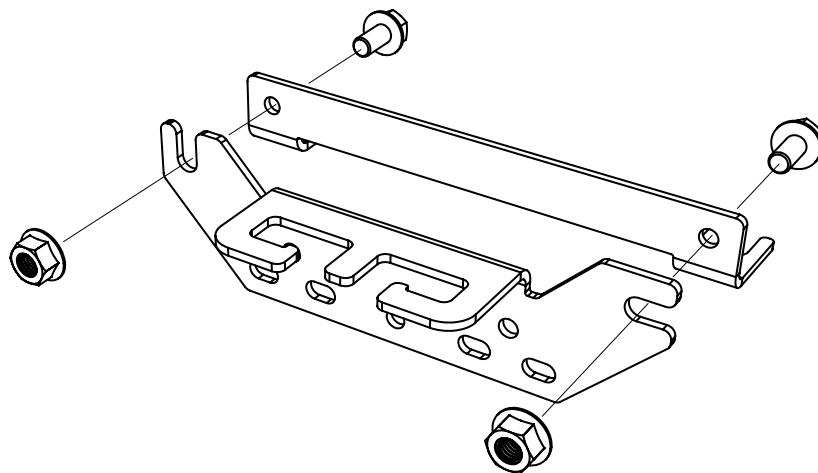

5

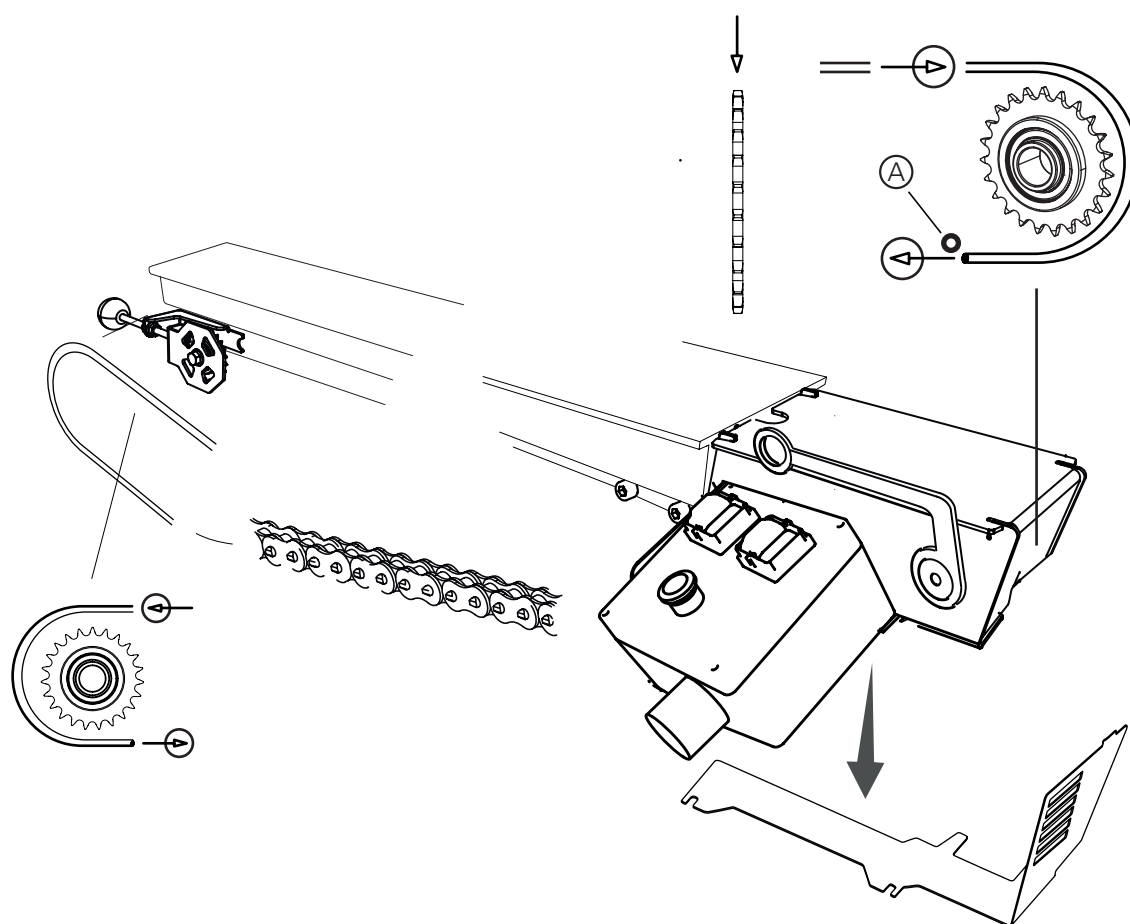

**Important:** Make sure that the wire is led below the safety bolt, which is located under the pulley.



6

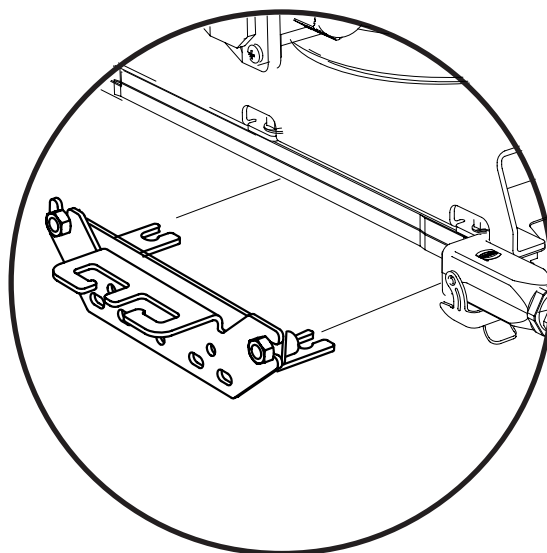
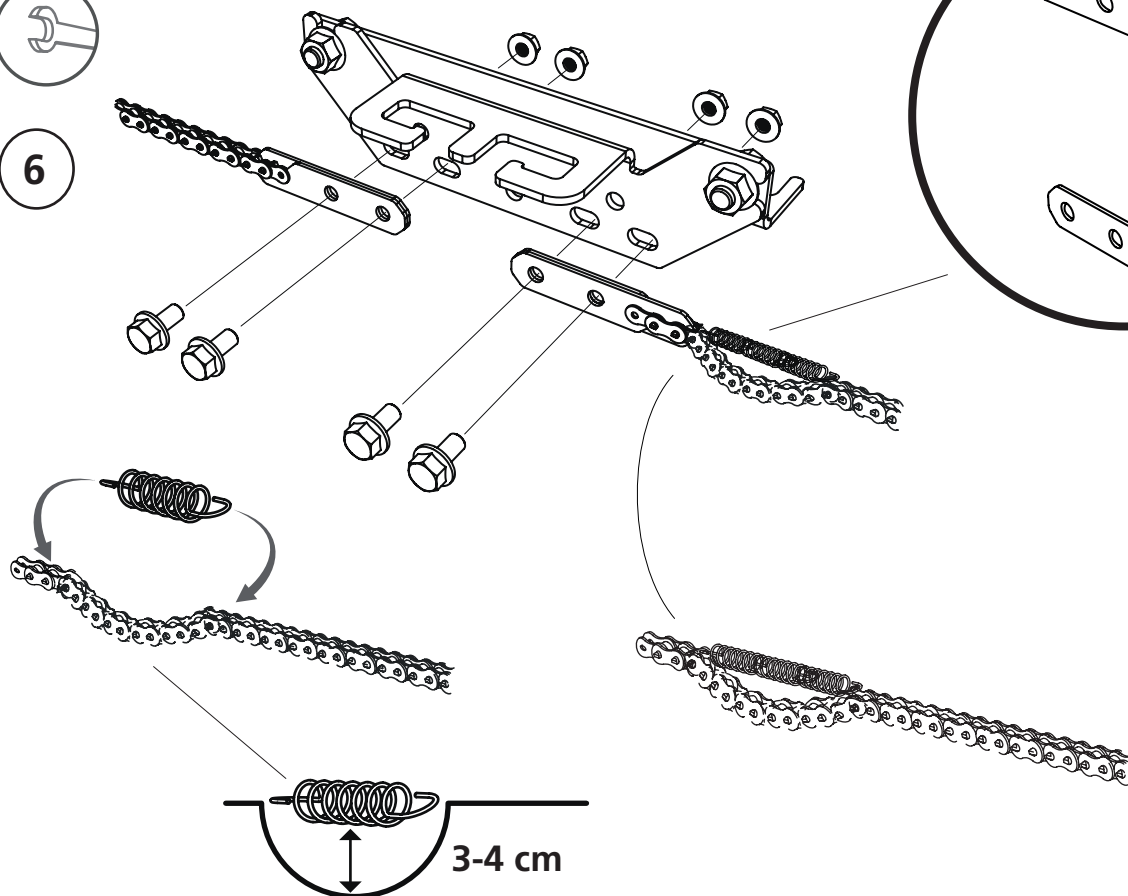

7



— 4 x — M6x16



— 4 x — M6

The assembly uses the existing sledbolts.

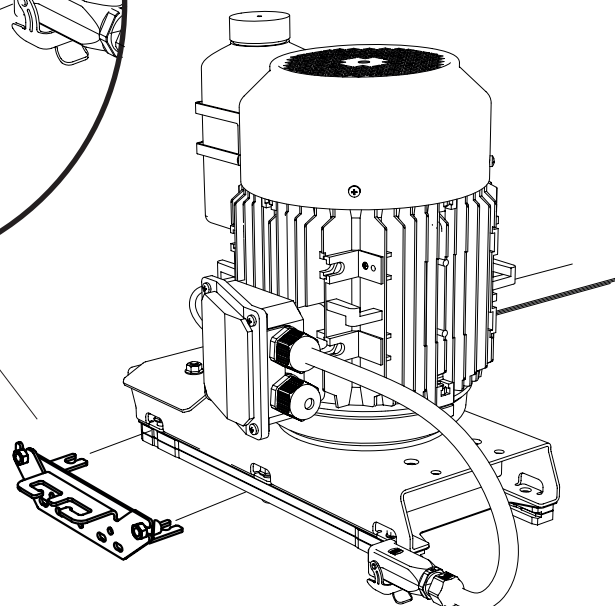





8

 — 2 st — Allen screw M6x20

 — 2 st — Flange nut M6

9

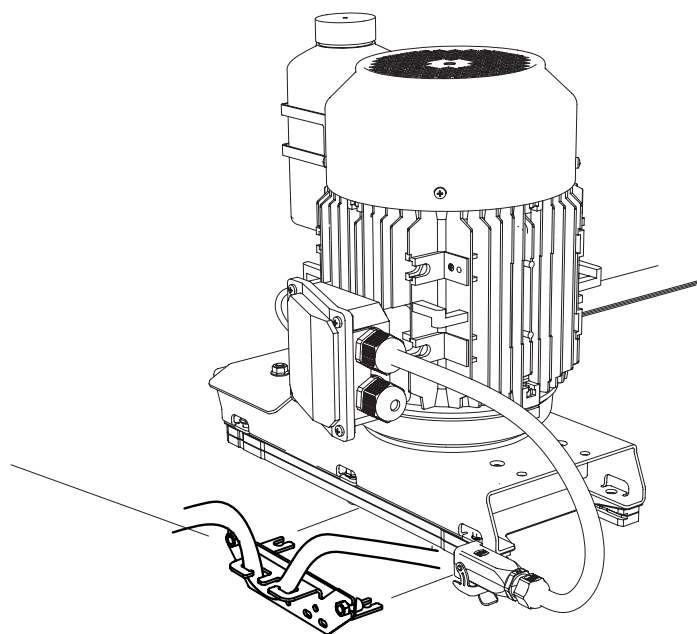
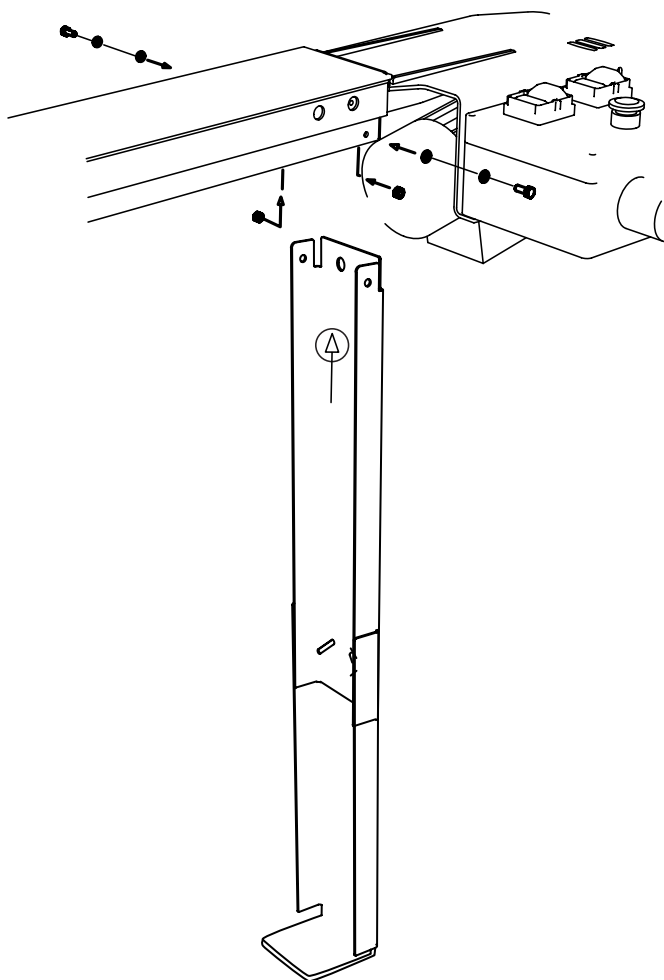
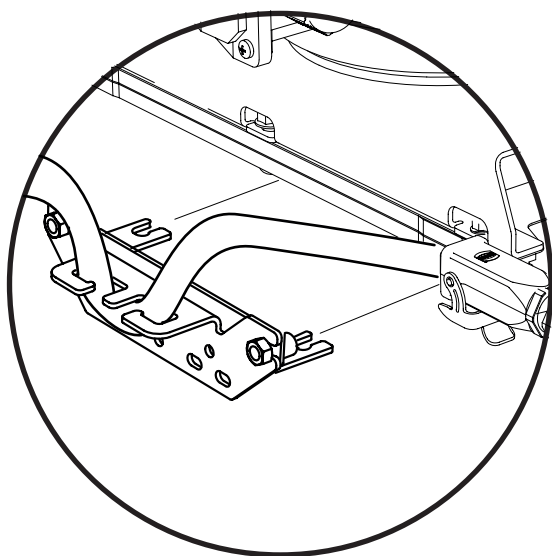



10

**Important:** It is important that the feed unit has the right wire tension to work satisfactorily. Tighten the wire until it stops slipping in the pulley. The wire tension may need to be readjusted after a period of use.

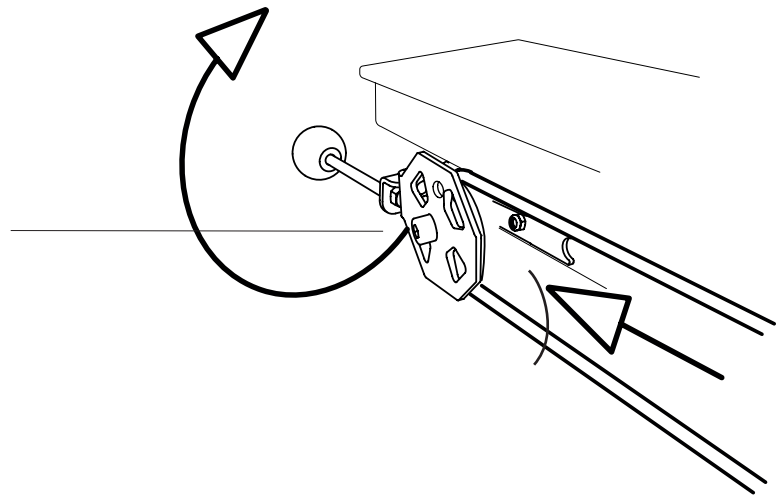

## ADJUSTMENT: SUPPORT LEGS

The support legs can be adjusted vertically by loosening the two adjusting bolts. Adjust the height of the support leg until it rests lightly against the ground.



**Important:** The supports legs should just rest lightly against the ground. The sawmill should put all its weight on the feet of the log lifters.

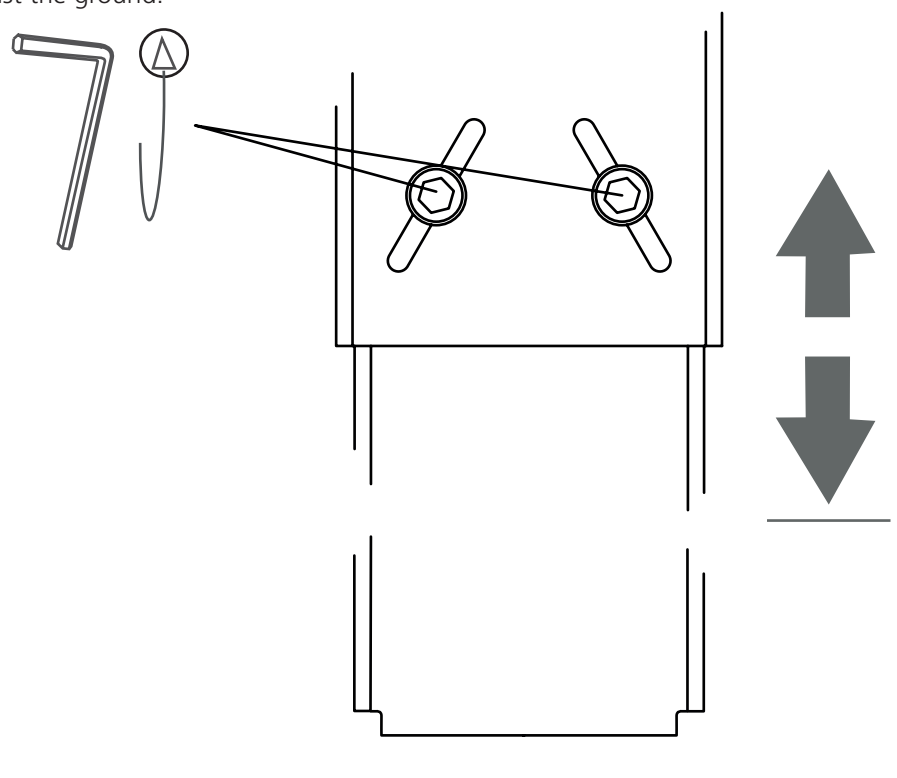

## ADJUSTMENT: NEUTRAL MODE

- 1** Position the saw unit at the centre of the guide rail.

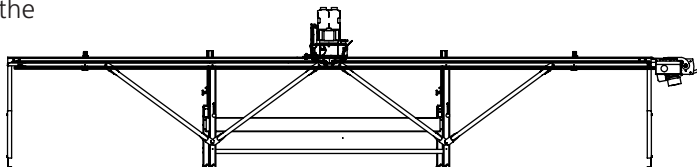

- 2** Check that the control lever is in its neutral position.

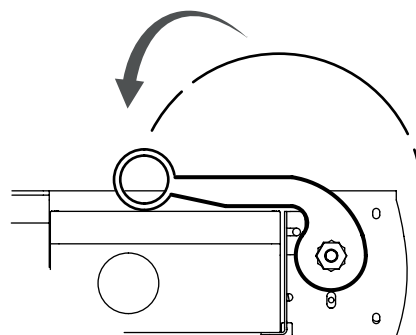

- 3** Unscrew the lock bolt from the control lever to reach the pressure bolt.

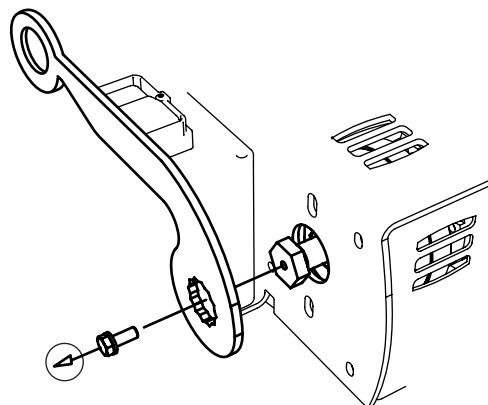

- 4** Loosen the pressure bolt.

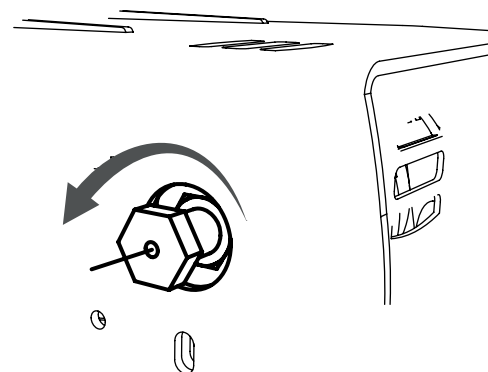

# ADJUSTMENT: NEUTRAL MODE

5

Press the B4: reverse feed button on the control panel.

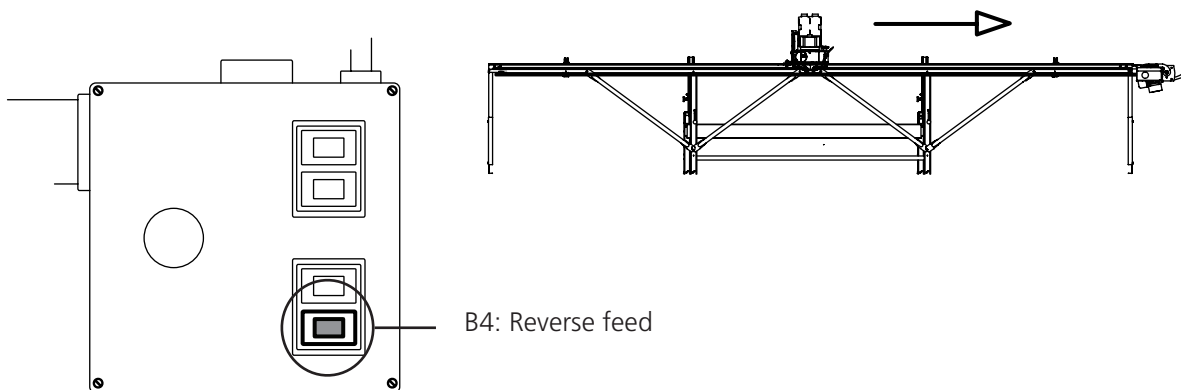

6

Tighten the pressure bolt until the saw unit just begins to move backwards. When this happens, you loosen the bolt slightly until the saw unit stops again.

**Tip:** Uses the control lever as a tool to facilitate adjusting the pressure bolt.

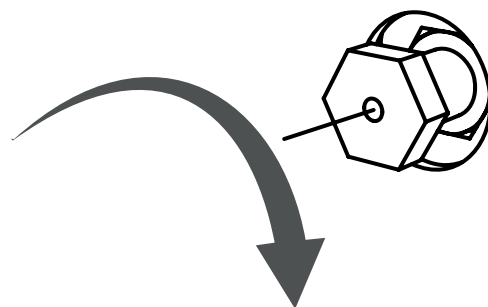

7

Reinstall the control lever in its neutral position.

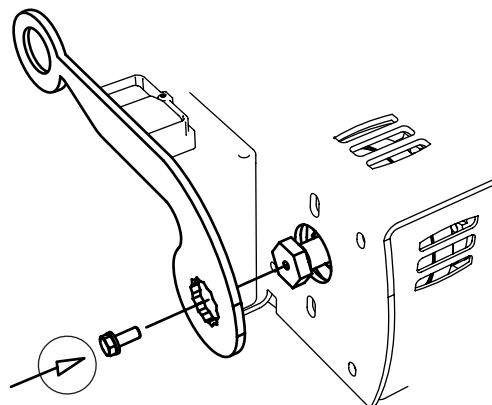

# CONTROL PANEL

With the control panel buttons you choose the desired function. During all types of forward processing you need to keep the enabling switch pressed down to enable operation.

**B1** Red: Stop 

**B2** Green: Start 

**B3** Black: –

**B4** White: Start

 **Important:** An enabling switch button is a pressure-sensitive switch. It has to be pressed down all the time during sawing and forward feed.

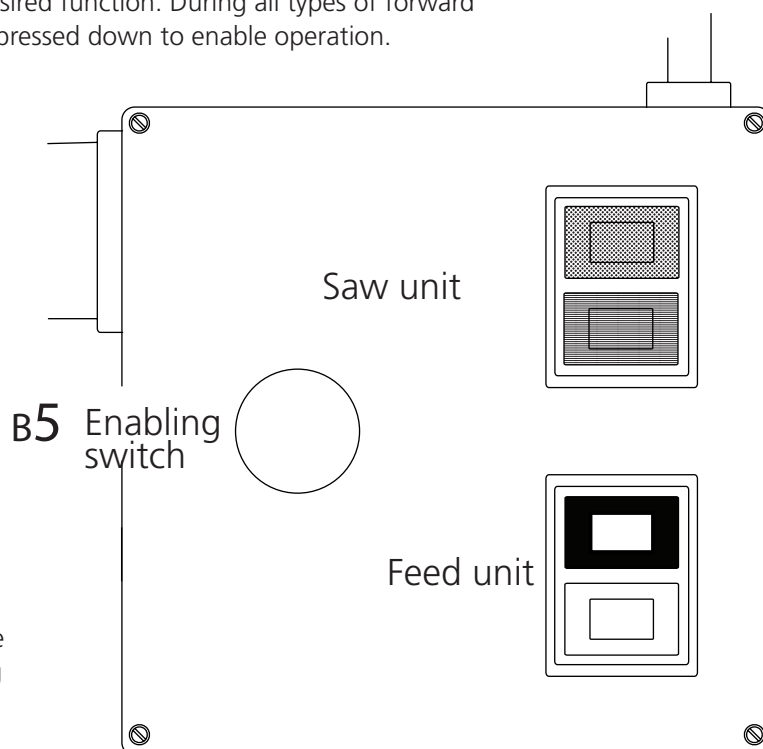

# CONTROL LEVER

With the control lever you control the feeding speed.

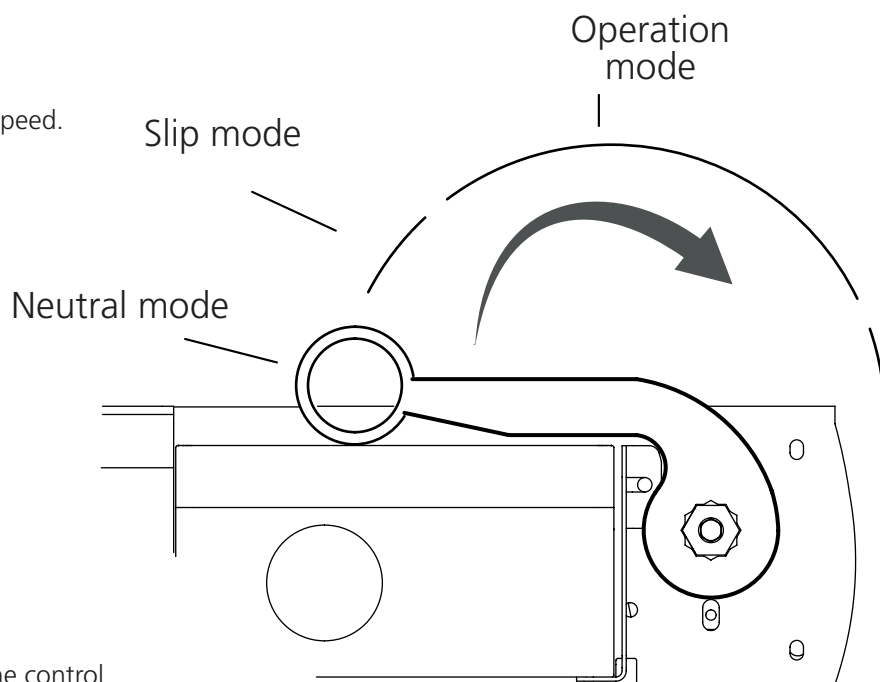

 **Danger:** When starting the feed unit, the control lever should always be in its neutral position.

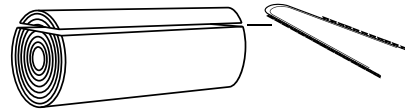
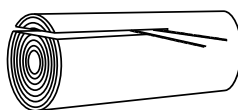
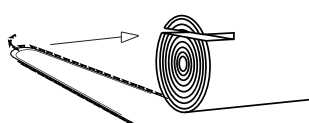

Slip mode

Operation mode

Stop



# OPERATION: FORWARD FEED

For forward feed, press down the enabling switch button, B5, with your left hand. With your right hand you first start the saw unit by pressing the B2 button, and then start the feed unit by pressing the B4 button. After that, you slowly pull the control lever with your right hand.

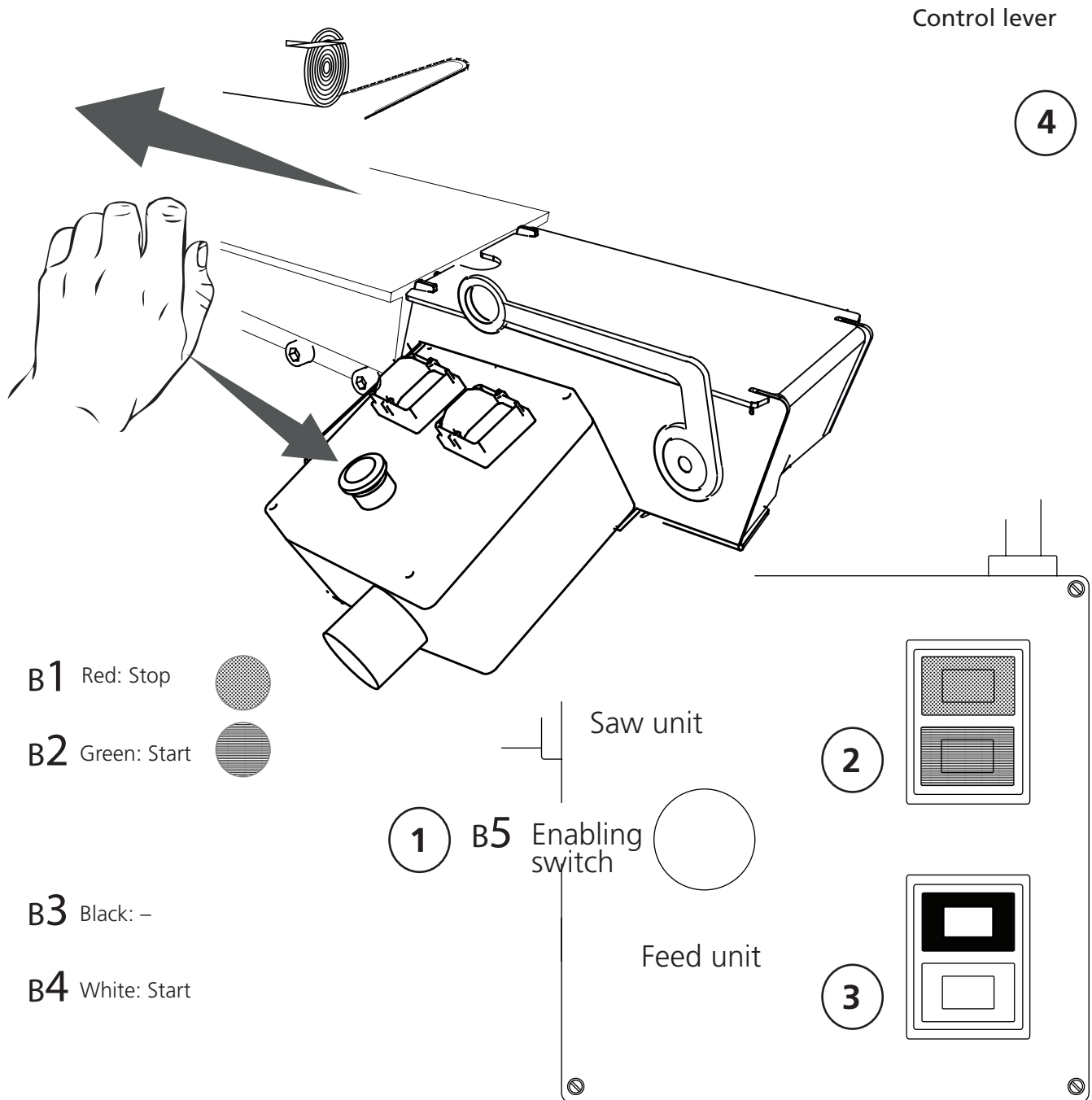

**Important:** When using the saw unit and forward feed, the enabling switch button has to be pressed down.



**Important:** To lower the stress on the equipment, it is important that the saw unit slowly enters the wood that is to be cut.

# OPERATION: REVERSE FEED

For reverse feed, press down the B4 button with your left hand while the control lever is pulled back with your right hand.

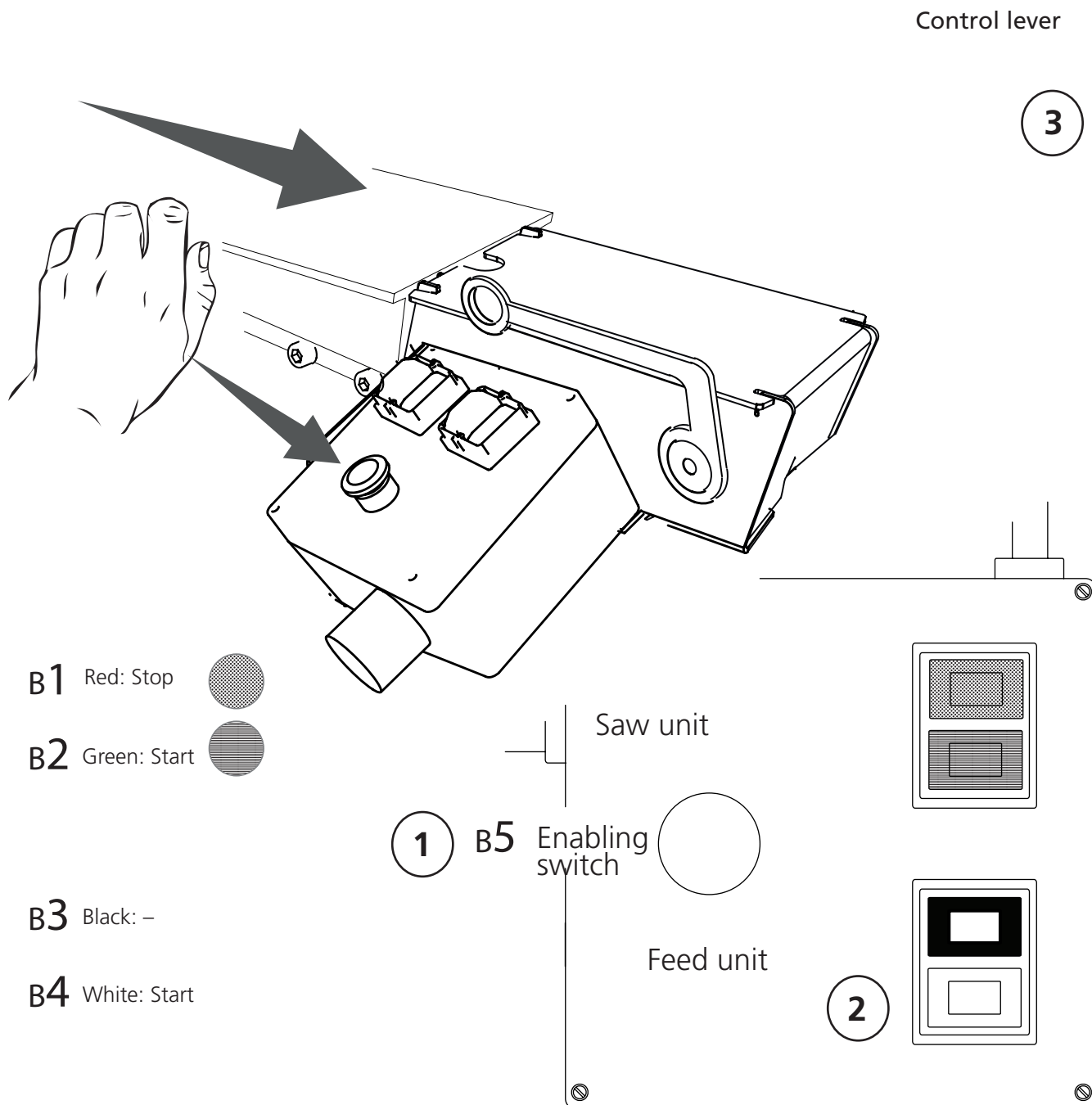

**Important:** During reverse feeding the B4 button has to be pressed down.

**Danger:** Risk of crushing and cutting injury when the saw unit backs in over the loading ramp.

# MAINTENANCE

The first hours of operation, the feed unit can run unevenly. The wire may need to be retightened a couple of times before it becomes fully stretched out, and it takes some time for the friction disc to be worn into the discs before full feeding pressure is attained. Also, the feeding pressure can pulsate a little, but this will decline in the course of time. If the pulsation become worse or does not decline after a couple of hours, read the section 'Trouble shooting' or contact Logosol.

Normally, the control lever has to be adjusted a couple of times during the first working day.



**Important:** Regularly check that no sawdust is building up in the pulleys. Be extra attentive when it rains, or when extremely wet or resinous timber is sawn. If this is overlooked there is risk that the wire wriggles off. Clean the pulleys with a thin piece of rigid plastic, or the like. Do not use tools of steel.

## Condensation

If the feed unit and the electric saw are stored outdoors or in an unheated place, there is risk that water condenses in the control panel and in the motors due to variations in temperature. Under adverse conditions, several decilitres of water can accumulate here.



**Danger:** Risk of electric shock and that the equipment becomes damaged.



**Important:** Check that there is no water in the system. The control panel and the motors have a drain plug or a bolt that can be opened to drain out any water that have accumulated. The control panel drain plug is located on the underside of the panel. On the feed motor it is located on the side of the motor. On the electric saw it is either located at the belt pulley or on the side of the motor. Accumulated water in the equipment does not constitute a reason to make complaints.

## Other maintenance

Cover the feed unit and the saw unit when they are not being used.

Long-term storage: Clean the feed unit and lubricate the ball bearings. Store the feed unit in a heated place to prevent condensation caused by variations in temperature.

When removing the paint on the top of the loading ramp: Rub off rust and paint flakes, wipe off with ethyl alcohol, and paint with black paint in order to keep the feed unit nice and clean.

Make sure that the label on the top of the loading ramp is intact and legible. If not, order a new label.



# MAINTENANCE

## Lubrication points

Check that the ball bearings always are lubricated. Use adhesive oil in the ball bearing of the clutch. Be careful not to use too much oil. One press on the adhesive oil can nozzle gives enough lubrication (ref. no: 9999- 000-5100). At the control lever side you remove the pressure bolt to reach the bearing of the secondary clutch disc. At the same time, lubricate the friction disc on both sides to prevent rust, and to get a smoother operation of the feeding. This can be done by loosening the pressure bolt about 5 mm and parting the clutch.

Lubricate the square-shaped rubber gasket of the 6-pole plug with a silicone lubricant (ref. no: 9999-000-5110). This should be done daily if the same feed unit is used for several machines and there is heavy wear on the gasket. Check that the gasket is not worn out and replace it if it breaks (ref. no: 9999-000-9999).

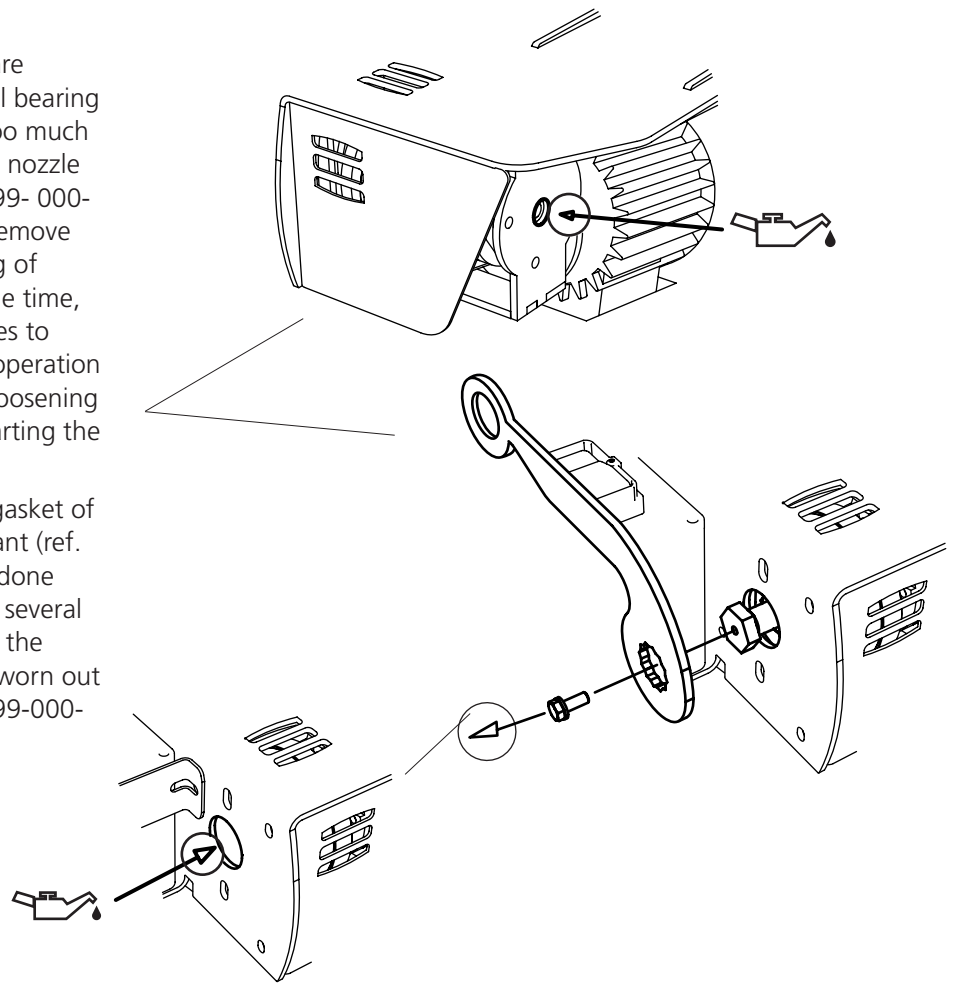

Lubrication of both sides of the friction clutch and the spindle. After maintenance is done, the neutral mode of the feed unit must be adjusted (see p.24)

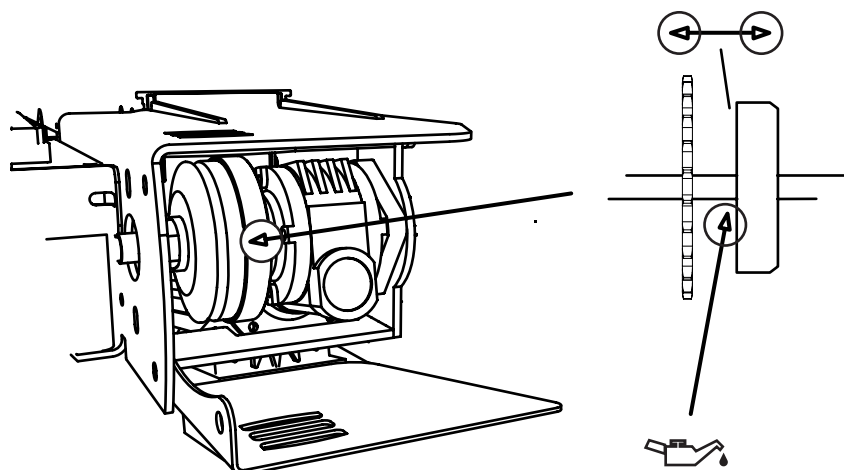

# TROUBLESHOOTING



**Important:** Always stop the machine if you suspect that something is wrong with

1. the wire tension
2. the track in the clutch disc
3. the lock pins in the spindle



**Important:** Check the saw unit and the cutting equipment. If the cutting equipment does not cut as it is supposed to, it can result in poor feeding.

## The feed unit does not start:

Do you press the enabling switch button (B5) down while you are trying to start the equipment? The enabling switch button must always be pressed down during sawing and forward feeding. See more about the functions of the enabling switch under the section *Operation: Forward Feed* on page 28.

## Feeding is weak:

- The feed wire is not tightened enough. Check the tension of the wire, see *Adjustment: Wire Tensioner* on page 23.
- Sawdust has accumulated in the wire track of the secondary clutch disc. Clean the track, see *Maintenance* on page 30.
- The feed wire runs above the safety bolt. It should run freely under the bolt. See page 19.

# WIRING DIAGRAM

## Circuit diagram

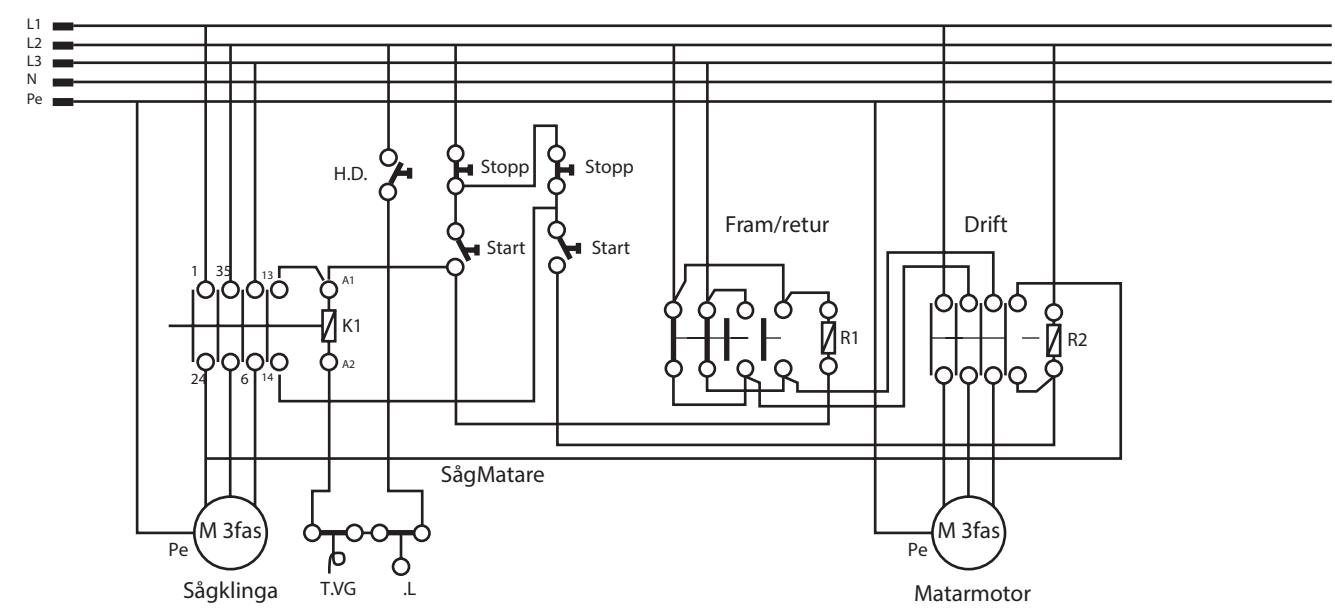

## Electrical components list

Complete terminal box: 6600-001-3027

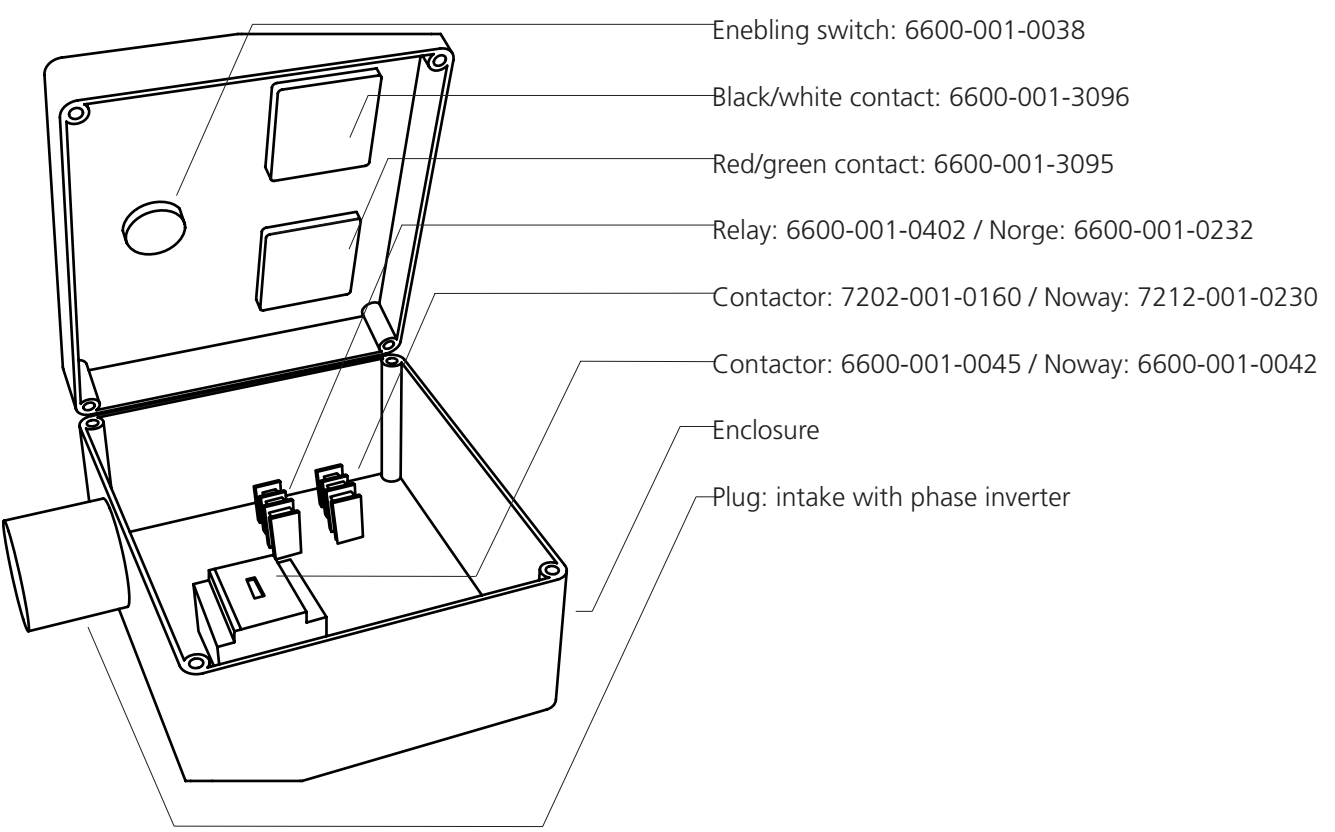



Arkiwägen 6, 871 53 Härnösand, Sweden  
+46(0)611-182 85 | [info@logosol.com](mailto:info@logosol.com) | [www.logosol.com](http://www.logosol.com)