

BRUKSANVISNING

BRUKSANVISNING I ORIGINAL

SKU: 0458-395-0868

REV: 3

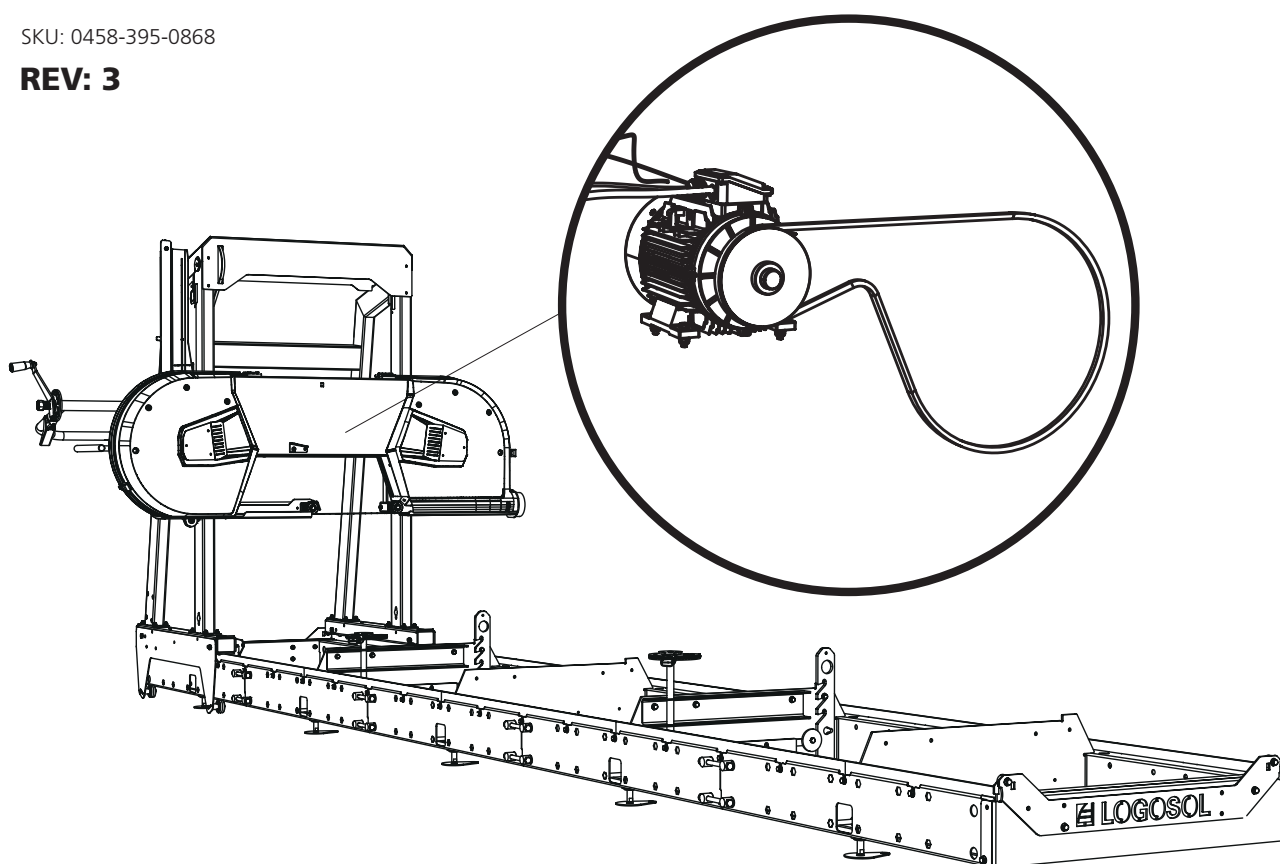

4.6 / 8 / 12 KW

Denne bruksanvisningen er et vedlegg for montering av elmotor til Logosols båndsaagbruk. For annen montering, sikkerhetsinstruksjoner og innstillinger, se bruksanvisningen for båndsaagbruket.



4,6 / 8 / 12KW



Les gjennom hele innstillingsanvisningen før du starter innstillingen, og følg deretter anvisningen trinn for trinn under innstillingen.



Etter monteringen følger du instruksjonene i sagbrukshåndboken under overskriften *Innstillingsrekkefølge* for å fullføre innstillingen før du starter maskinen.



1

Elmotoren leveres med hengselbryteren tilkoblet. Monteringen består av å installere motoren på motorhyllen samt montering av reimskiven og drivreimen. Illustrasjonene viser hullbildene som brukes til montering av elmotorer på 4,6 / 8 / 12 kW. Følg monteringsanvisningen, og gå gjennom maskinens innstillingsrekkefølge når monteringen er ferdig.

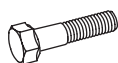

4 x – M10x40



4 x – M10



8 x – M10

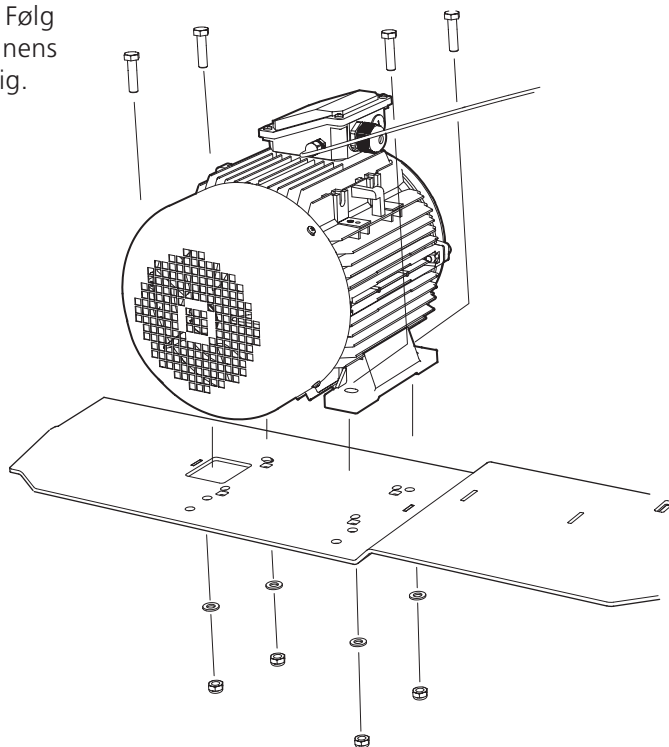

Sett ovenfra:

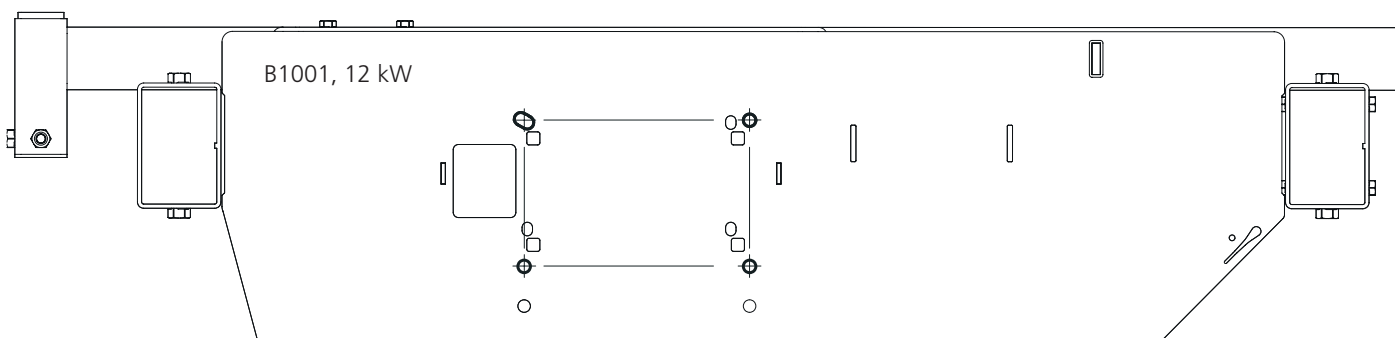
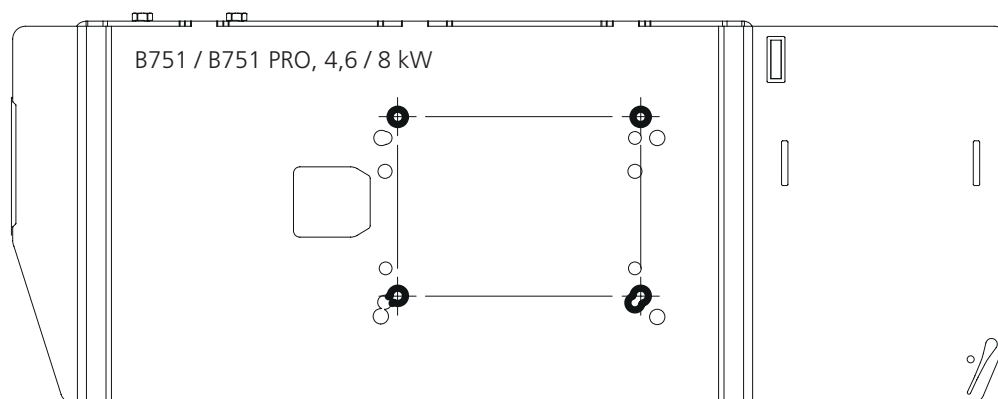



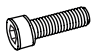

2

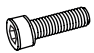
 2 x – M6x25

 2 x – M6x30

 1 x – 03-01997
10mm

 1 x – 03-02080
12mm

 2 x – 03-02182

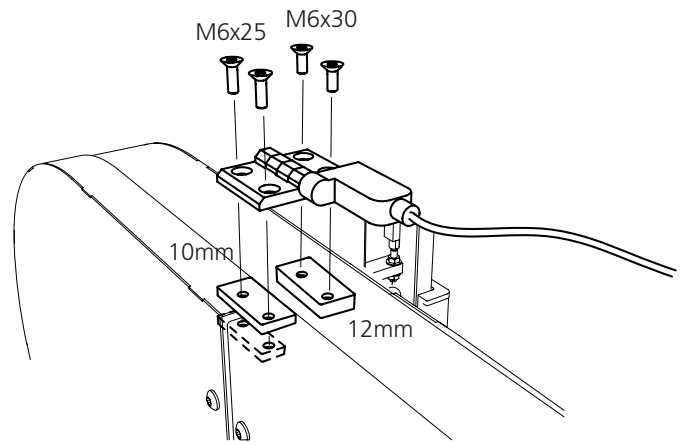

4,6 / 8 KW

3

 1 x

 1 x

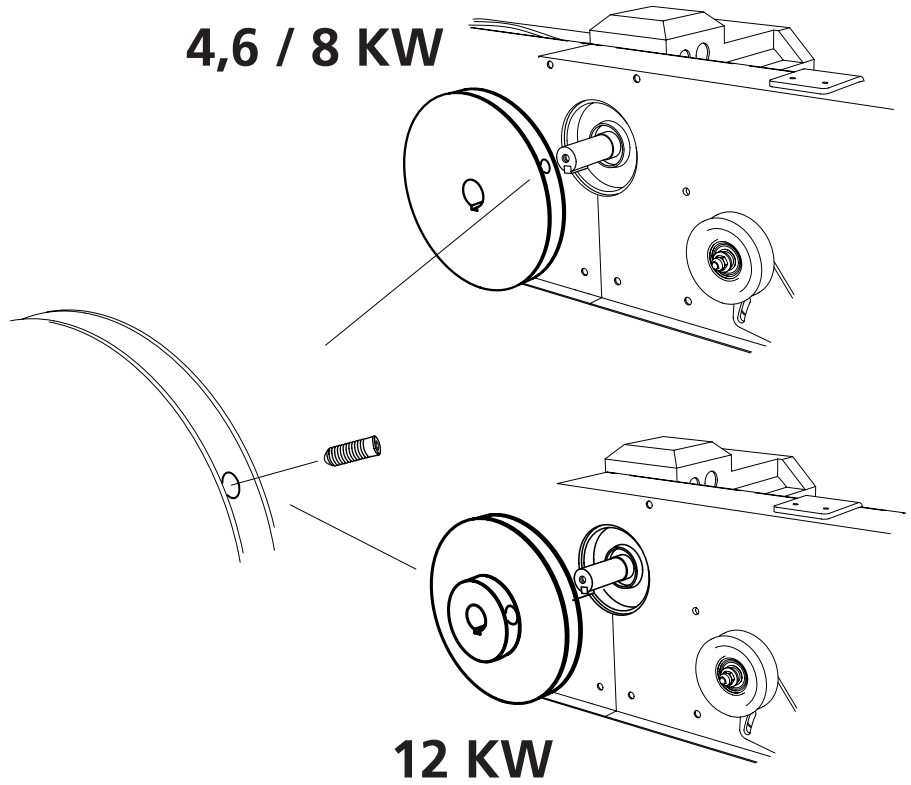

12 KW





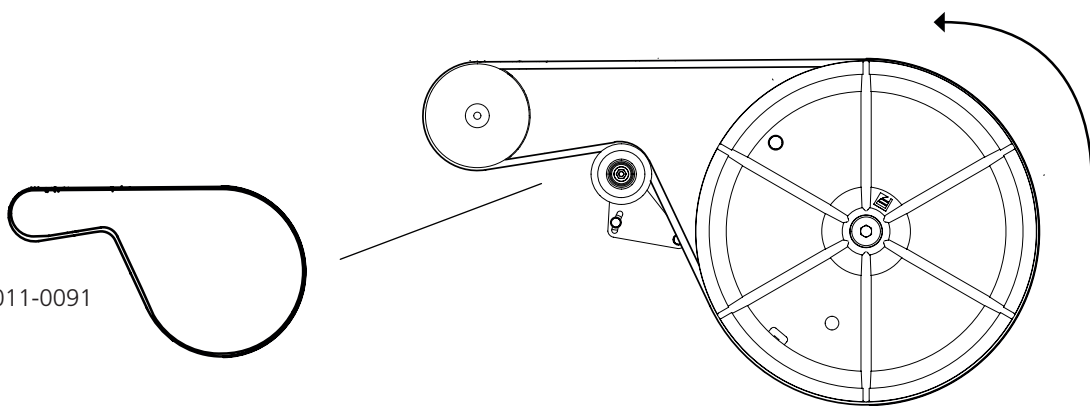

4

1 x - 9020-011-0091

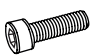

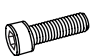
5

-  4 x - M6x12
-  4 x - M8
-  2 x - M8x60
-  2 x - M8
-  2 x - M8

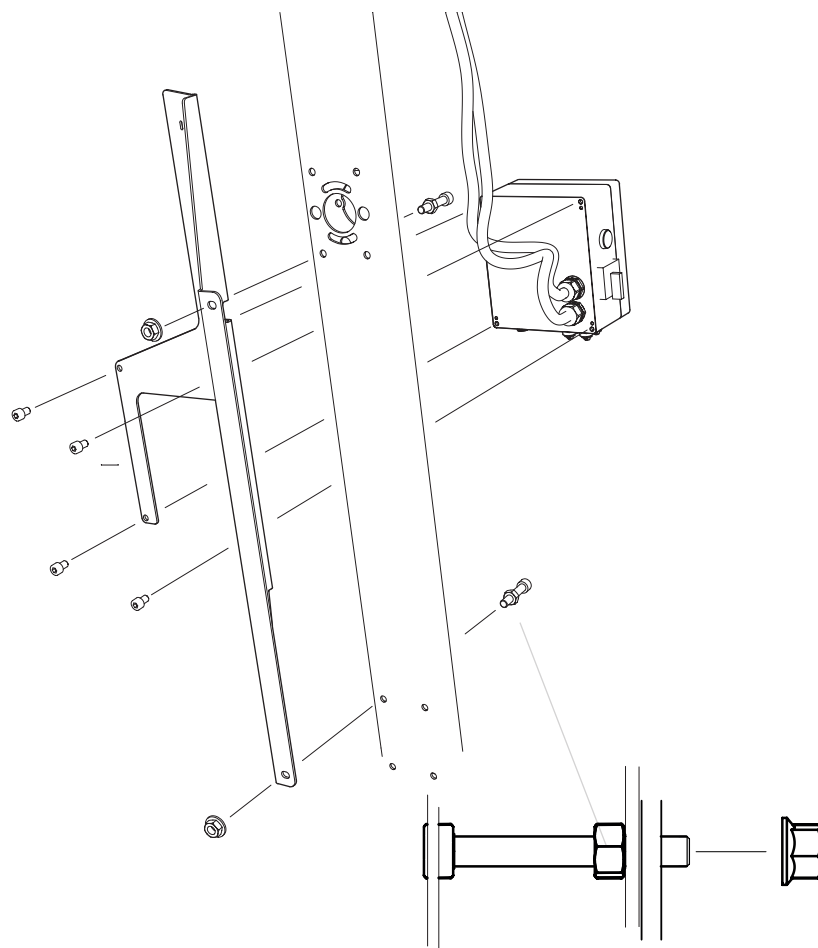

6

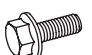
-  2 x - M6x10

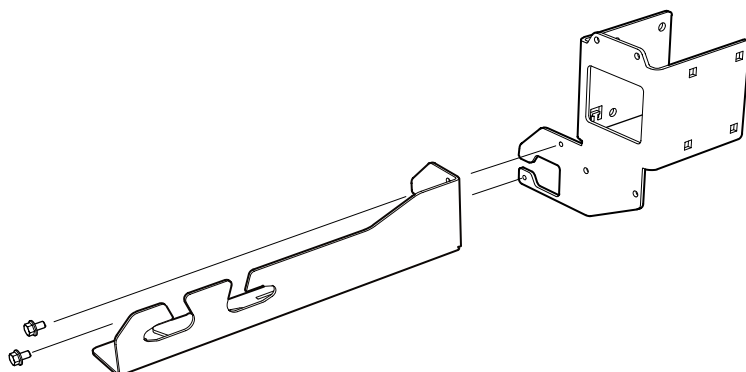

LOGOSOL



7

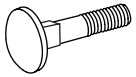

4 x - M8x120



4 x - M8

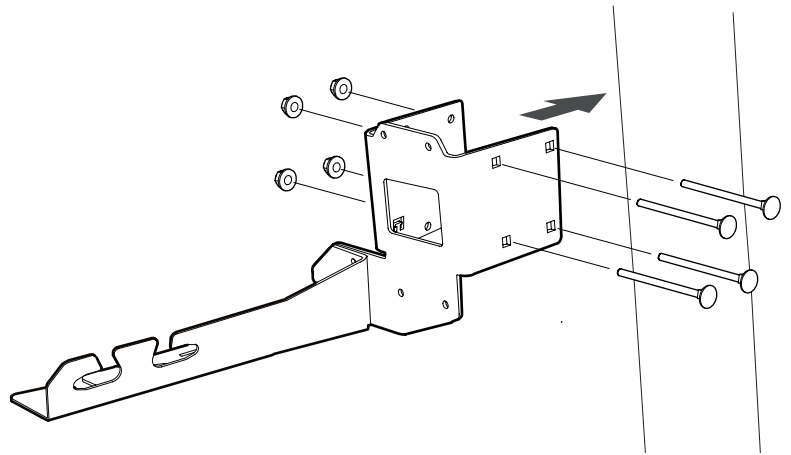

8

A



4 x - M6x16

B



2 x - M5x16



4 x - M6

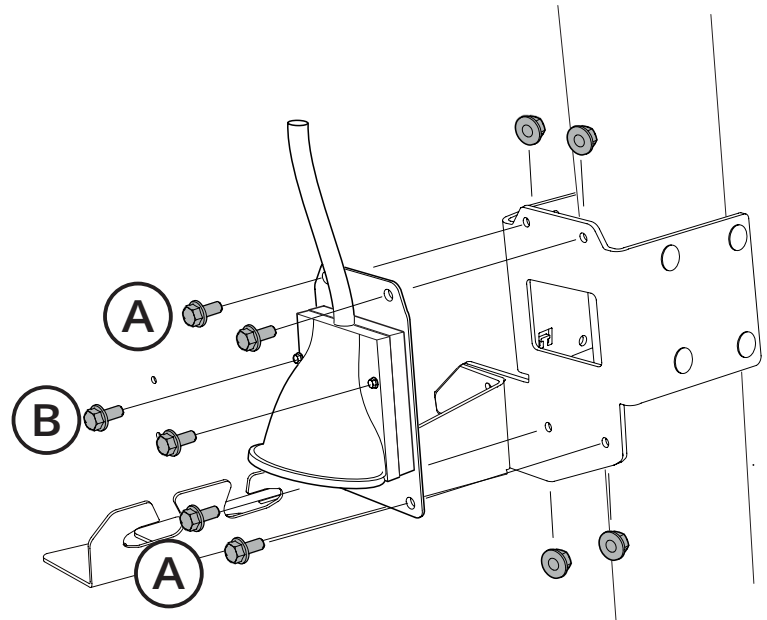

9

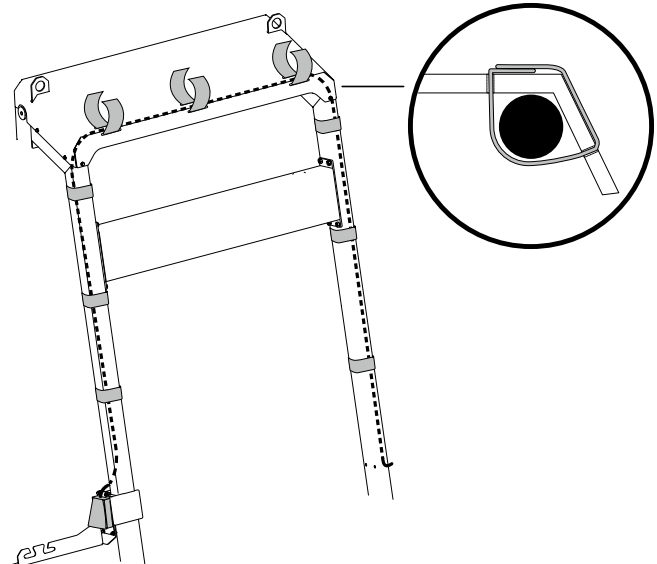



10

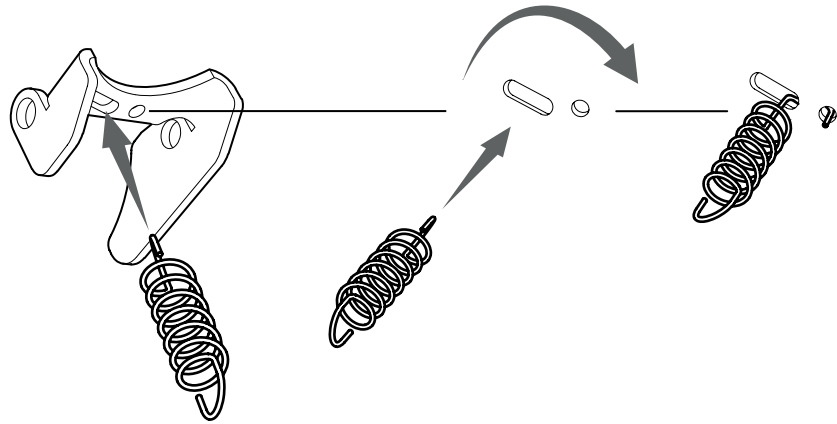

11

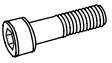

1 x - M5x50



1 x - M5

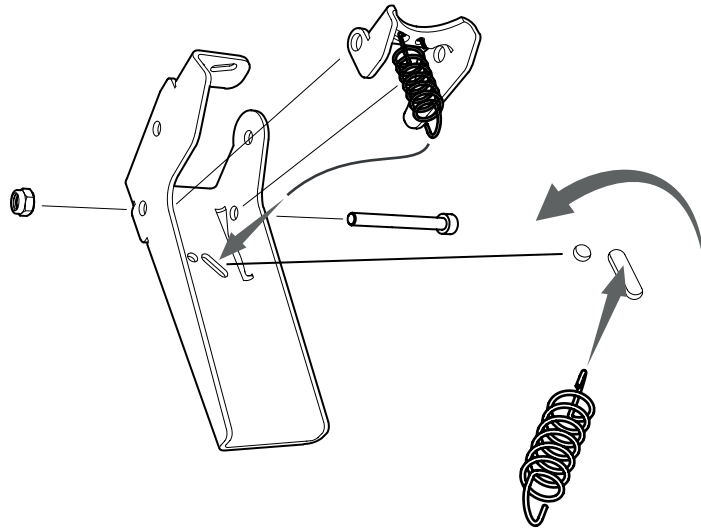

12

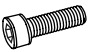

2 x - M5x16

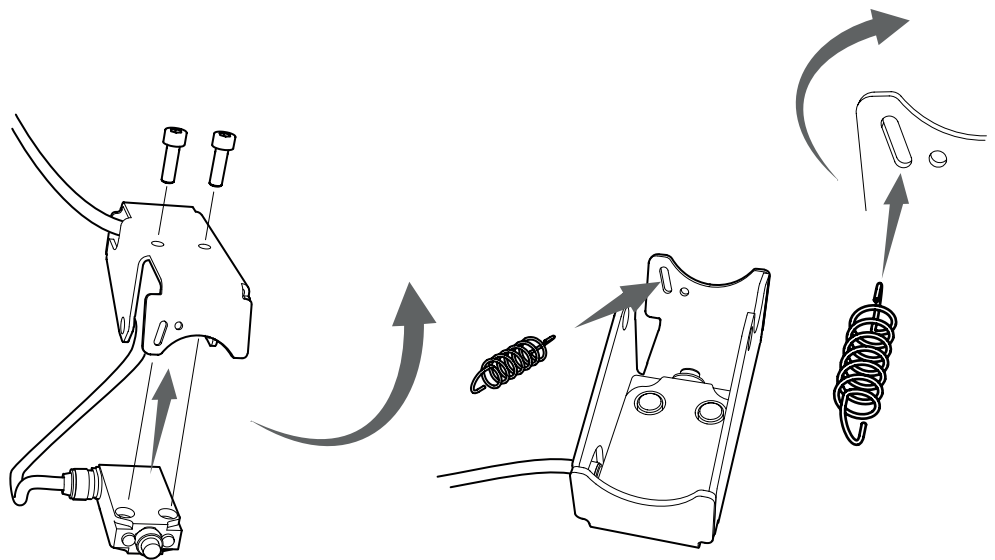



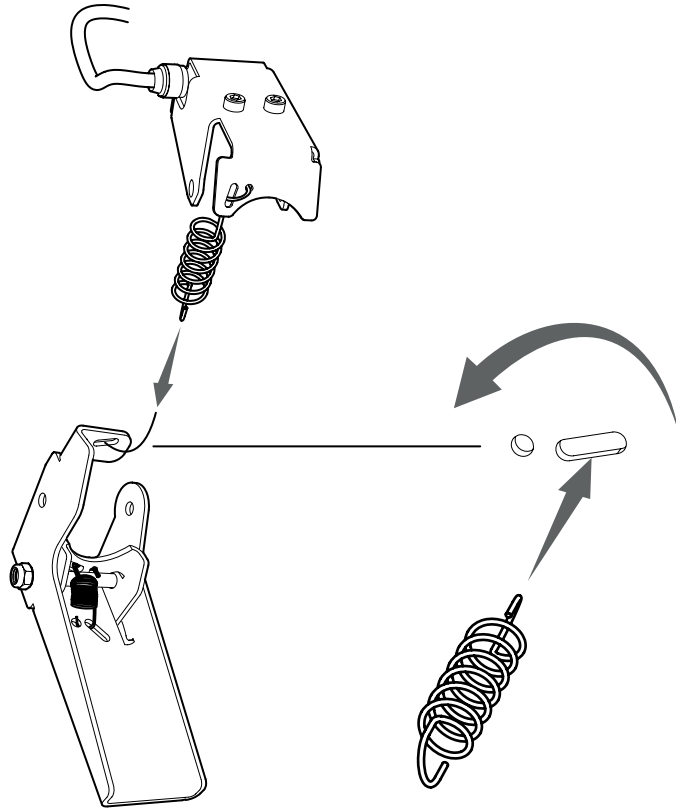

13

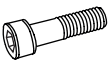
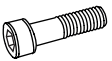

14

-  1 x – M6x50
-  1 x – M5x50
-  1 x – M6
-  1 x – M5

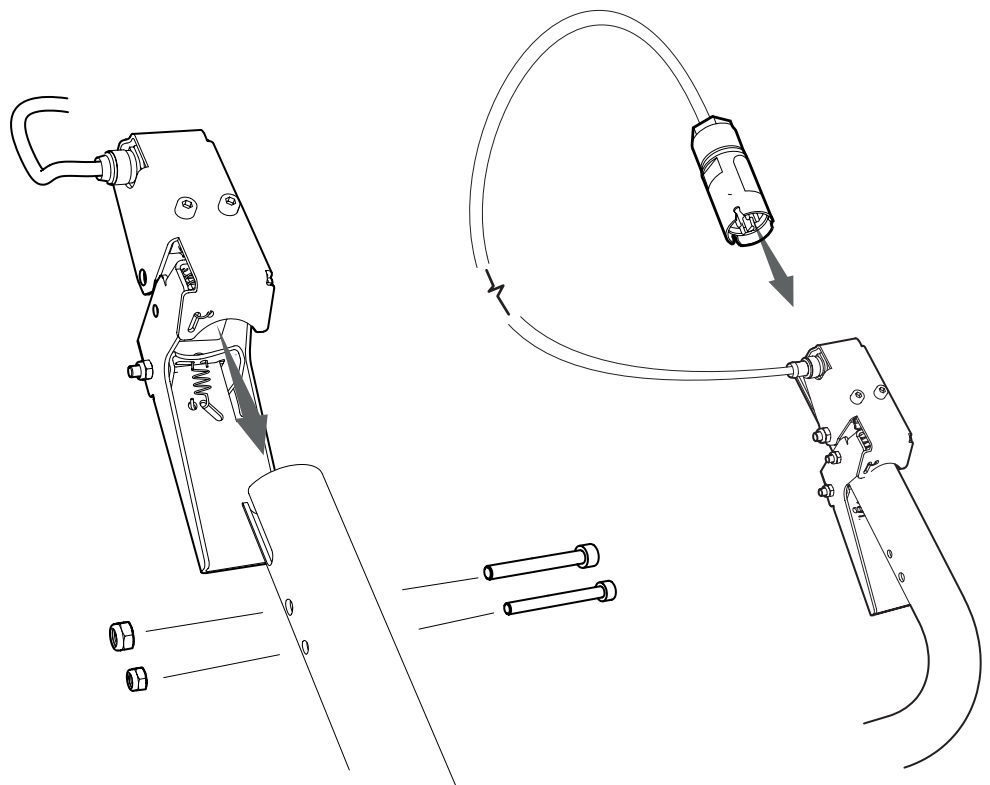



15

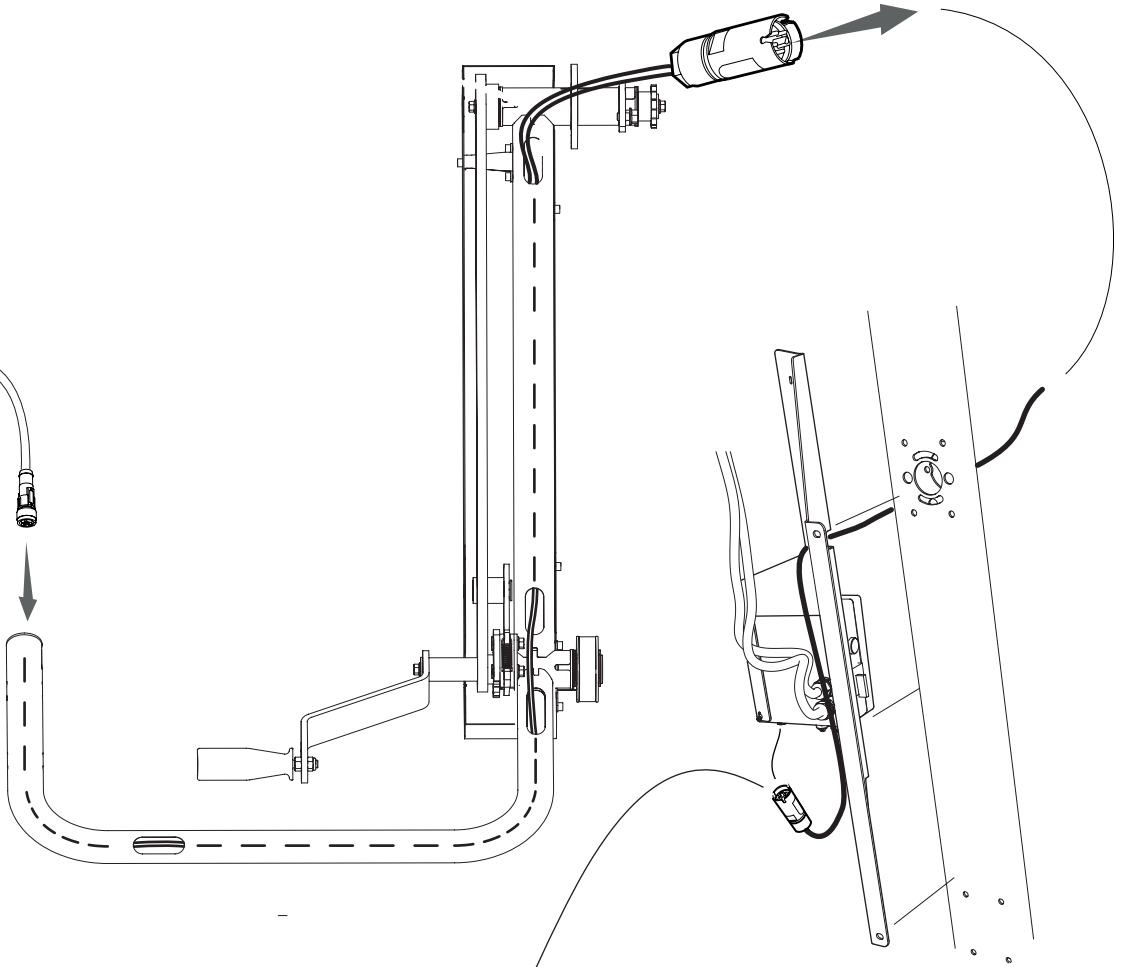
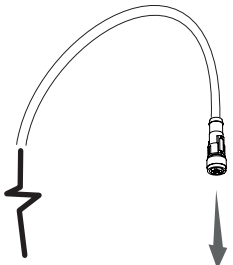

16

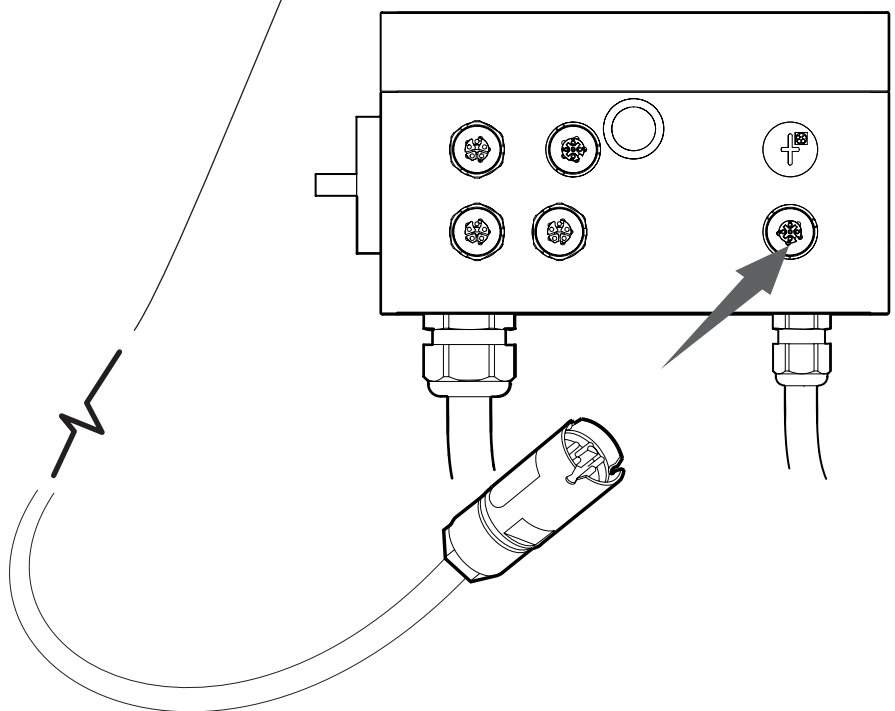

SLÅ ELEKTRISK KONTAKT AV/PÅ

Vri den elektriske kontakten på (1) for å slå på strømmen til maskinen.

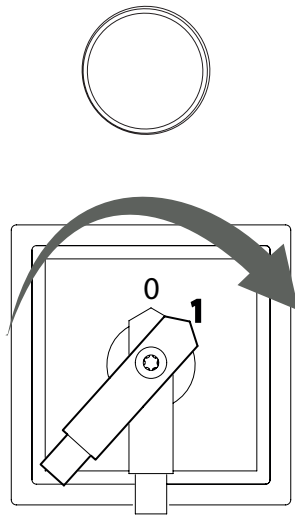

START MOTOREN

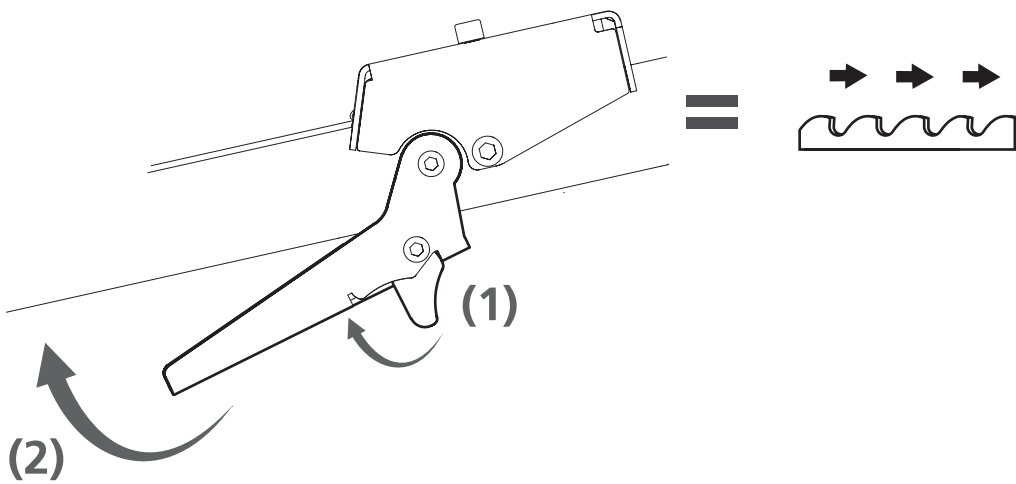



Godt jobbet!

Nå er monteringen av motoren fullført, og du bør nå gå tilbake til håndboken for båndsg bruket og fortsette med innstillingsrekkefølgen i henhold til instruksjonene nedenfor.

INNSTILLINGSREKKEFØLGE



Les gjennom hele innstillingsanvisningen før du starter innstillingen, og følg deretter anvisningen trinn for trinn under innstillingen.



VIKTIG!

For å sikre at sagbruket fungerer som det skal, er det viktig å justere inn saghodet før start for at det skal gi tilfredsstillende sageresultat. Følg innstillingsrekkefølgen nøye! Enkelte justeringer påvirker andre maskininnstillinger.



Arkivvägen 6, SE-871 53 Härnösand, Sweden
+46 611-182 85 | info@logosol.com | www.logosol.com